

**PAPER 2 LISTENING** (approximately 30 minutes, including 8 minutes transfer time)

**PART 1**

**QUESTIONS 1–5**

You will hear five short conversations.

You will hear each conversation twice.

There is one question for each conversation.

For questions 1–5, put a tick ☒ under the right answer.

**EXAMPLE**

0 What time is it?



A ☐



B ☐



C ☒

1 What have they forgotten?

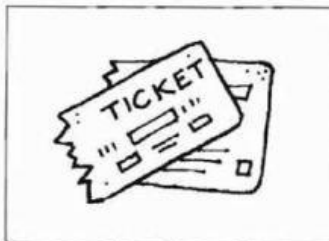

A ☐

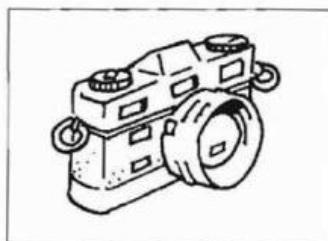

B ☐



C ☐

2 What time does the train go?

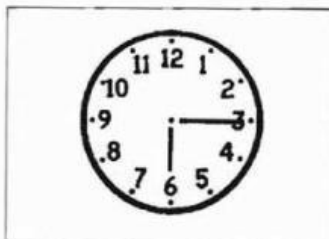

A ☐

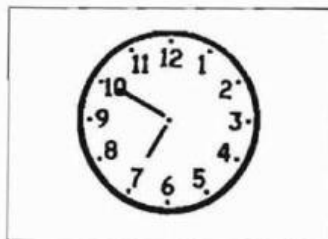

B ☐

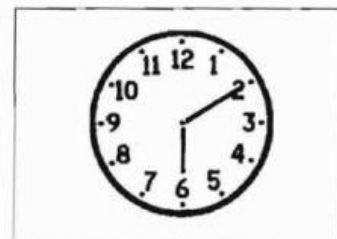

C ☐

3 Where is Room 22?

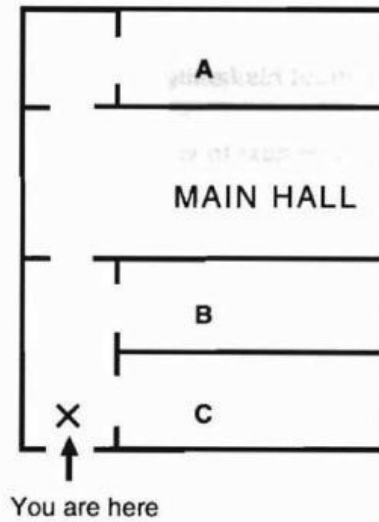

A ☐

B ☐

C ☐

4 Which man wants to see him?



A ☐



B ☐



C ☐

5 How did the woman get to work?

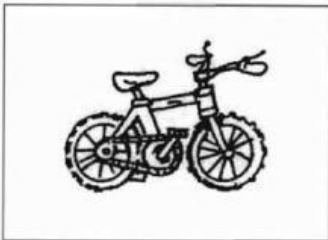

A ☐



B ☐

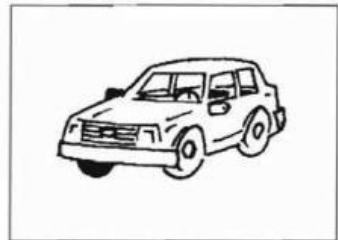

C ☐

Test 1

**PART 2**

**QUESTIONS 6–10**

Listen to Paul talking to a friend about his family.

What does each person do?

For questions 6–10, write a letter A–H next to each person.

You will hear the conversation twice.

EXAMPLE	ANSWER
0 Sally	<div>H</div>

PEOPLE		JOBS
6 Bill	<div></div>	A bank clerk
7 David	<div></div>	B doctor
8 Paul's mother	<div></div>	C farmer
9 Paul's father	<div></div>	D shop assistant
10 Paul	<div></div>	E stopped work
		F student
		G teacher
		H writer

**PART 3****QUESTIONS 11–15**

Listen to Eric talking to Mary about the weekend.

Their friend, Carlos, is coming to visit them.

For questions 11–15, tick ☒ A, B or C.

You will hear the conversation twice.

EXAMPLE	ANSWER
0 What does Carlos hate?	
A shopping	<input checked="" type="checkbox"/>
B museums	<input type="checkbox"/>
C football	<input type="checkbox"/>
11 When is the football match?	
A Saturday morning	<input type="checkbox"/>
B Saturday afternoon	<input type="checkbox"/>
C Sunday afternoon	<input type="checkbox"/>
12 Where are they going to eat on Saturday evening?	
A at home	<input type="checkbox"/>
B in an Italian restaurant	<input type="checkbox"/>
C in a Chinese restaurant	<input type="checkbox"/>
13 What are they going to do on Sunday morning?	
A go for a drive	<input type="checkbox"/>
B get up late	<input type="checkbox"/>
C go to the cinema	<input type="checkbox"/>

Test 1

14 Where are they going to have lunch on Sunday?

A in a café

☐

B in a pub

☐

C at home

☐

15 They can't go to the cinema on Sunday afternoon because

A Carlos doesn't like films.

☐

B Eric doesn't like films.

☐

C they don't have time.

☐

**PART 4****QUESTIONS 16–20**

You will hear a telephone conversation.

A girl wants to speak to Martin, but he is not there.

Listen and complete questions 16–20.

You will hear the conversation twice.

<b>Phone Message</b>		
To:	<b>Martin</b>	
From:	16	<input type="text"/>
Party at:	17	<input type="text"/>
Time:	18	<input type="text"/>
Please bring:	19	<input type="text"/>
Her phone number:	20	<input type="text"/>

## PART 5

### QUESTIONS 21–25

You will hear some information about a travel agency.

Listen and complete questions 21–25.

You will hear the information twice.

## South Seas Travel Agency

New phone number: 847 2296

New address: 

21	98		Road
----	----	--	------

Opposite: 

22	
----	--

Opens on: 

23	
----	--

Book a holiday for: 

24	£	
----	---	--

and get a free: 

25	
----	--

You now have 8 minutes to write your answers on the answer sheet.