

## IT SUPPORT- 1

1. Label the diagram with these tools (in bold) from the advertisement.

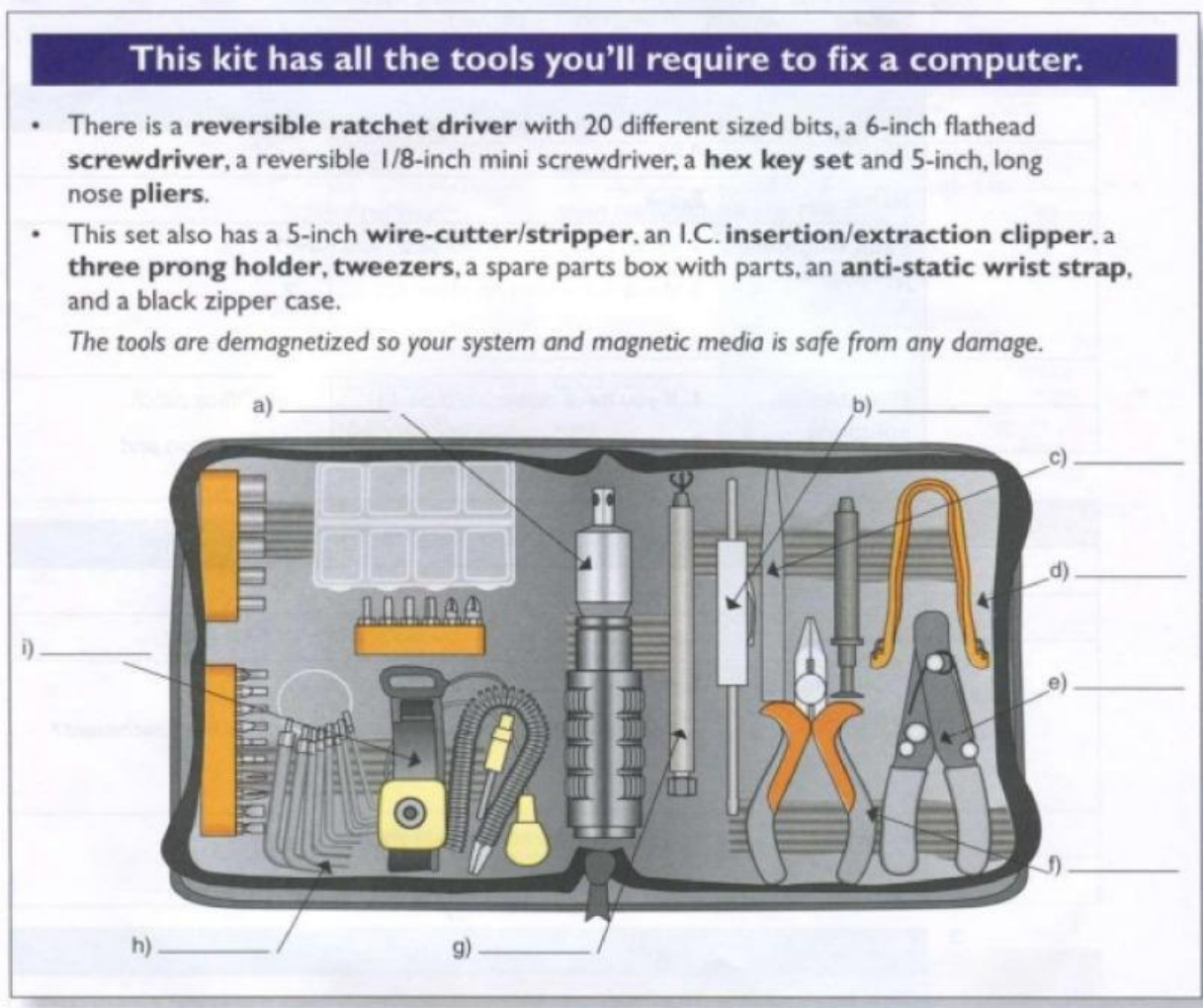

2. Vocabulary:

Match the tool 1-8 to its use a-h. Write the letters.

- |   |                              |
|---|------------------------------|
| 1 | reversible ratchet driver    |
| 2 | screwdriver                  |
| 3 | hex key                      |
| 4 | pliers                       |
| 5 | wire cutter/stripper         |
| 6 | insertion/extraction clipper |
| 7 | tweezers                     |
| 8 | anti-static wrist strap      |

1	—
2	—
3	—
4	—
5	—
6	—
7	—
8	—

- |    |  |
|----|--|
| a) | used for inserting and removing fibre connectors in tight spaces |
| b) | used to prevent electrostatic discharge                          |
| c) | used for tightening and removing screws                          |
| d) | used for easy driving of screws and nuts                         |
| e) | used to hold small objects                                       |
| f) | used to hold objects, cut or bend tough materials                |
| g) | used to drive bolts and screws into a hexagonal socket           |
| h) | used for cutting wire or removing the insulation                 |