

SECTION 1

Questions 1-10

Complete the notes below.

Write **NO MORE THAN TWO WORDS AND/OR A NUMBER** for each answer.

Birmingham Exhibition

<i>Example</i>	<i>Answer</i>
<i>Purpose of calling:</i>	<i>purchasing tickets</i>

- Open in: **1**.....
- Length of exhibition: **2**.....
- A wide range of manufacturers will be showcased.
- Some cars are available to observe and the others are for **3**.....
- The **4**..... is prohibited to take into the museum.
- Every ticket includes one free photo.
- Price of ticket: £ **5**..... (in advance)
- Transfer to Mark **6**..... (Box Office Manager)
- Held in the **7**..... Palace this year
- Not far from **8**.....
- Website: www. **9**..... .com
- Best way to contact: **10**.....

SECTION 2

Questions 11-15

Choose the correct letter, **A**, **B** or **C**.

- 11** How many patients does the hospital consult every year?
- A** 3,000
 - B** 5,000
 - C** 11,000
- 12** When can patients meet the female doctor?
- A** on weekday mornings
 - B** three days a week
 - C** only on Mondays and Fridays
- 13** Who is the expert on treating hearing loss?
- A** Mr. Robert
 - B** Mr. Green
 - C** Mr. Edwards
- 14** Where are patients recommended to buy their medicine?
- A** the supermarket in the town
 - B** pharmacies nearby the city centre
 - C** the health care's pharmacy
- 15** What will the patients be asked about whether they are willing to do?
- A** Letting one student attend the consultation
 - B** Asking postgraduate students to do treatment
 - C** Meeting students in group discussion

Questions 16-20

Label the map below.

Write the correct letter, **A-H**, next to questions **16-20**.

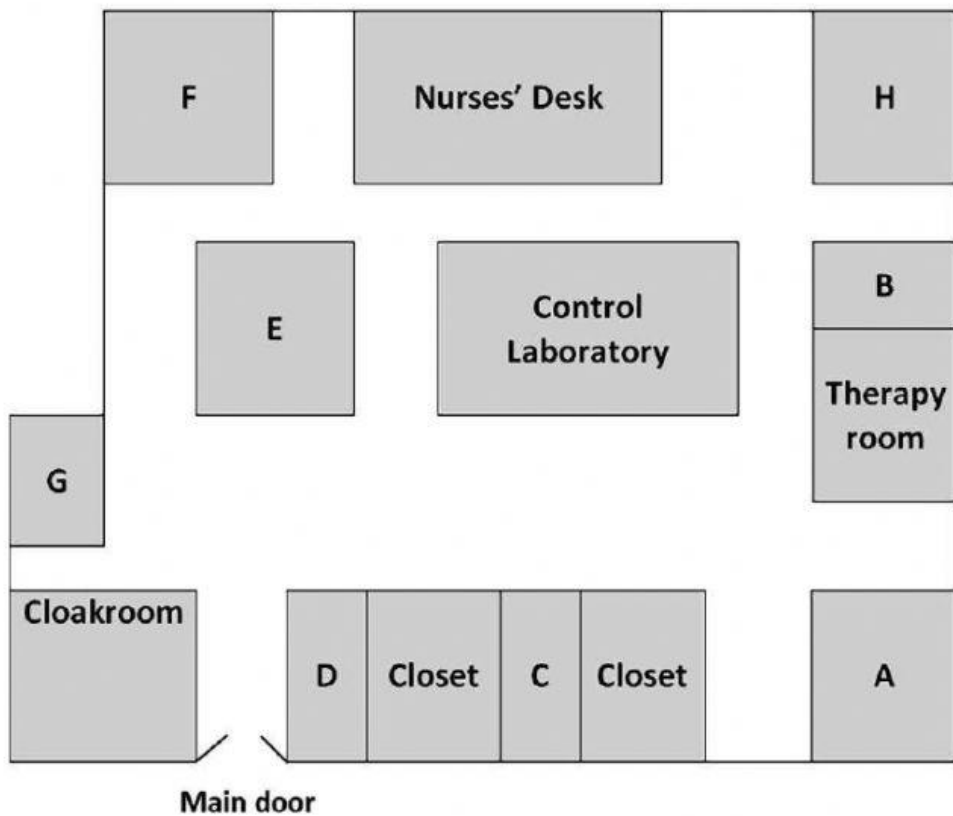

16 Reception

17 Mr. Green's Room

18 Medical Records Office

19 Surgery Room

20 Manager's Office

SECTION 3

Questions 21-25

What is the main opinion of each of the following people?

Choose **FIVE** answers from the box and write the correct letter, **A-G**, next to questions **21-25**.

Opinions

- A** lighting restrictions
- B** alternative lighting
- C** reduce the number of insects
- D** decline in the number of species
- E** climate changes
- F** impacts on the growth of animals
- G** impacts on water quality

- 21** Ken Simpson
- 22** Dave Kepler
- 23** Sharon Grey
- 24** Maria Jackson
- 25** Barbara Swallow

Questions 26-27

Choose the correct letter, **A**, **B** or **C**.

26 What does Jim think about the difference among species in natural and artificial light?

- A** It makes no difference.
- B** Species will die out in natural light.
- C** Species will die out in artificial light.

27 One reason why Jim and Jane felt unsatisfied about the theories discussed in the lecture was that

- A** governments didn't increase any spending on them.
- B** most theories had nothing to do with the exams.
- C** many theories lacked solid proof in the field.

Questions 28-30

Choose **THREE** letters, **A-G**.

Which **THREE** topics are they interested in studying in the future?

- A** quality of life of tourists
- B** wildlife park animals
- C** migration birds
- D** animals living in rural areas
- E** animals living in tropical climate
- F** the impacts of different environment on animals
- G** pandas in the zoo

SECTION 4

Questions 31-32

Choose **TWO** letters, **A-E**.

Which **TWO** aspects did the new rules at the end of the 19th century focus on?

- A** cooperation
- B** competition
- C** moral values
- D** player's physical protection
- E** business model

Questions 33-40

Complete the sentences below.

Write **ONE WORD ONLY** for each answer.

Football in the UK

At present the main reason why UK schools push football education is the pressure from **33**.....

Prior to the 19th century, football players used different **34**..... of rules.

People attempted to standardise the rules from the whole **35**....., known as the 'Cambridge Rules' in 1848.

Attendances were increasing due to the improvement of infrastructure and the **36**..... system.

Football became popular and it is regarded as a **37**..... event.

The football clubs were responsible for most of the **38**..... and development for the football association.

39..... against other teams were also organised by the football clubs.

In 1910s, **40**..... football players were approved of in the game.