



Practice Test 5

Instructions to follow

-  Listen to the [audio](#) and answer the questions below

Part 1

Questions 1-2

Instructions to follow

- Choose the correct letter A, B C or D.

1 Where do they plan to travel?

-  A ☐ the coast
B ☐ the mountains
C ☐ Sydney
D ☐ the desert

2 Where do they plan to stay during the holiday?

- A ☐ a motel
B ☐ a hotel
C ☐ a youth hostel
D ☐ a holiday house



Questions 3

Instructions to follow

- Choose **THREE** letters A-F.

3 What will they take with them?

A ☐ B ☐ C ☐ D ☐ E ☐ F ☐

- A mosquito net
- B insect repellent
- C thick coats
- D medicines
- E binoculars
- F camera



Questions 4-5

Instructions to follow

- Choose the correct letter A-D or A-C.

4 How much money do they need for the tour?

- A ☐ \$480
B ☐ \$490
C ☐ \$500
D ☐ \$300

5 How will they pay the house fee?



- A ☐ with the traveler's cheque
B ☐ with the credit card
C ☐ with the saving card

Questions 6 - 10

Instructions to follow

- Answer the following questions with **NO MORE THAN TWO WORDS** for each answer.

When will they depart for the holiday?

6 _____

Where is the place they are going to stay located?

Opposite 7 _____



Why do many tourists go to this place?

Do **8** _____

Which **TWO** things in the bushes should they be careful about?

9 _____

10 _____



Part 2

Questions 11-15

Instructions to follow

- Label the diagram below.
- Write **NO MORE THAN TWO WORDS** for each answer.

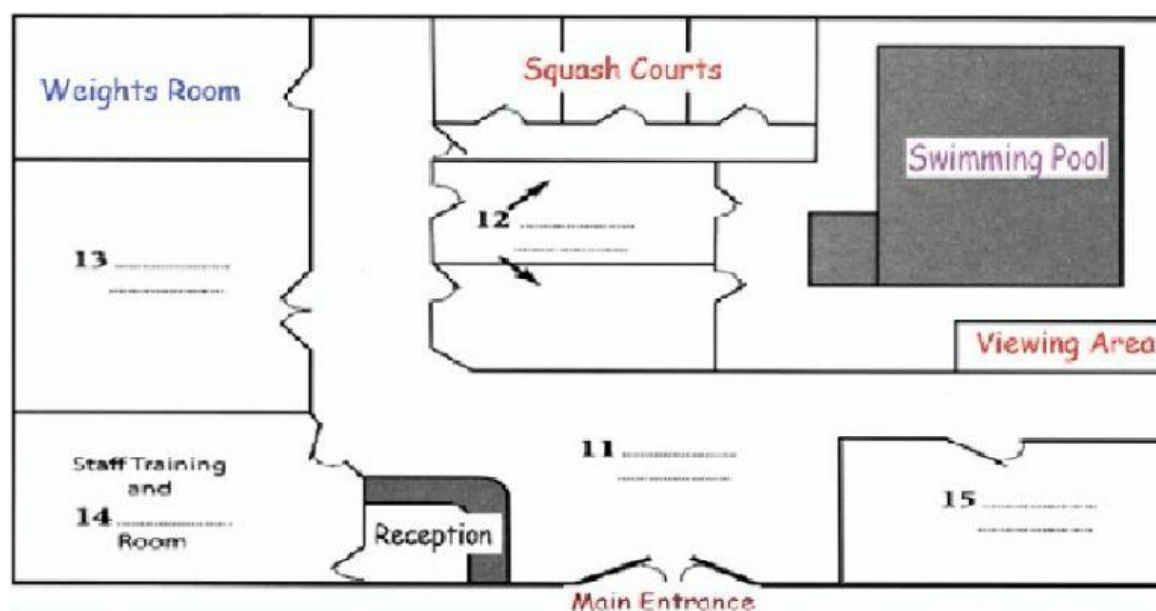

- 11 _____
- 12 _____
- 13 _____
- 14 _____
- 15 _____



Questions 16-20

Instructions to follow

- Complete the table below.
- Write **NO MORE THAN TWO WORDS AND/OR A NUMBER** for each answer.

| Membership Type | Cost | Access | Additional Benefits |
|-----------------|---------------------------|--|---|
| Anytime | ¹⁶ | Any time between 5 a.m. and midnight | Access to ¹⁷ clubs nationwide. |
| Free time | £500 | Between 10 a.m. and 3 p.m. | Access to ¹⁸ |
| Standard | £400 | Same as Free time but only ¹⁹ | None |



| | | | |
|----------|--------------------------|--------------------------------|--------------------------------|
| Children |20..... discount | Depends on choice of scheme | Depends on choice of scheme |
|----------|--------------------------|--------------------------------|--------------------------------|



Part 3

Questions 21-23

Instructions to follow

- Complete the sentences below. Write **NO MORE THAN THREE WORDS** for each answer.

- 21 The best days for engineering students are
- 22 Students can get useful suggestions about
- 23 Use the internet to look atbefore the event.

Questions 24-27

Instructions to follow

- Choose the correct letter A, B or C.

- 24 Fergus says that
- A ☐ there is one company he is particularly interested in
 - B ☐ he has done some research already
 - C ☐ he knows the boss at one of the companies
- 25 The tutor thinks Fergus should
- A ☐ prepare questions in advance
 - B ☐ research the skills required for jobs before the event
 - C ☐ find out what the starting salaries are
- 26 Fergus plans



- A ☐ to wear a suit and tie
- B ☐ to wear smart but casual clothes
- C ☐ to buy an outfit for the event

27 The tutor suggests that Fergus

- A ☐ should ask particular people certain questions
- B ☐ should avoid taking free gifts
- C ☐ should treat conversations like short interviews

Questions 28-30

Instructions to follow

- Choose **THREE** letters A-F.

Why do the tutor and Fergus think it is useful to attend a jobs fair?

- A to get a job
- B to find out what employers want from you
- C to give employers your contact details
- D to discover which are the key companies to work for
- E to practice your communication skills
- F to make useful contacts

28 _____

- A ☐ B ☐ C ☐ D ☐ E ☐ F ☐

29 _____