

Lesson 7: Workplace, Life, and Community Skills

A Look at the floor plan. Then complete the conversations about the building.

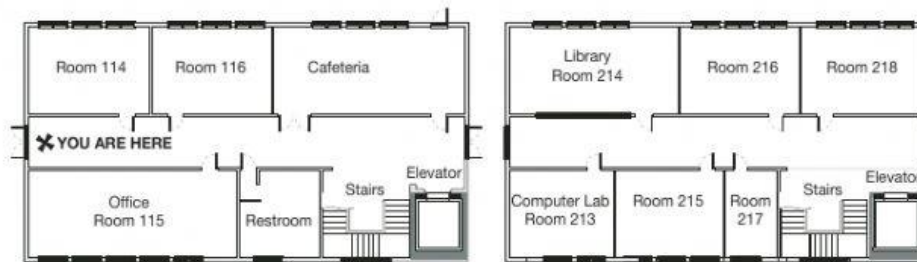

- A:** Excuse me. Where is the restroom?

B: It's on the right, across from the cafeteria.
- A:** Where is _____?

B: It's on the left, across from the stairs.
- A:** Where is _____?

B: It's across from the office, next to Room 116.
- A:** Which way is _____?

B: It's upstairs, Room 213. It's across from the library.
- A:** Which way is _____?

B: It's upstairs next to the library.

B Look at the floor plan in Exercise A. Answer the questions.

- Where's Room 114?
It's across from the office.
(across from)
- Where's the cafeteria?
_____.
(next to)
- Where's the elevator?
_____.
(across from)

DIRECTORY

	Room
Cafeteria _____	1. <u>17</u>
Computer Lab _____	2. _____
Library _____	3. _____
Main Office _____	4. _____

C Listen. Complete the directory.