

## A SHORT INSPECTION REPORT

1. Look at the technical drawing of a machine part. Answer the questions.

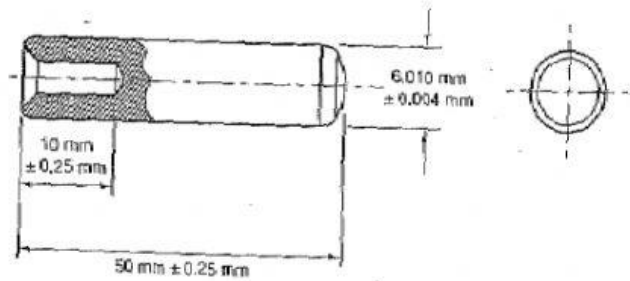
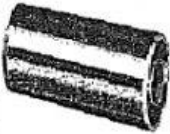

- 1) How long should the part be?
  - 2) What diameter should it have?
  - 3) What's the maximum length the actual part can be?
  - 4) What's the minimum length?
  - 5) What about the minimum and maximum diameter?
  - 6) What about the minimum and maximum hole depth?
2. Read the inspector's measurements on the prototype. Complete the inspection report.

	Inspector's measurements	
	length	50.4 mm
	diameter	6.009 mm
	hole depth	10.012 mm

### Inspection Report 16A

Item number 95846UK

Accept ☐ Reject ☐

The \_\_\_\_\_ of the piece is out of tolerance. According to the drawing, it should be between \_\_\_\_\_ and \_\_\_\_\_. The piece is \_\_\_\_\_ rejected. There may be a problem with the lathe. Please check it.