

## HOMEWORK

### Exercise 1<sup>41</sup>. (File 4)

**Task 1.** You will hear a dialogue between two students. One of them is describing a route on the map. Draw a line to show the route taken. If the student went inside any of that place named on the map, mark that place with a cross

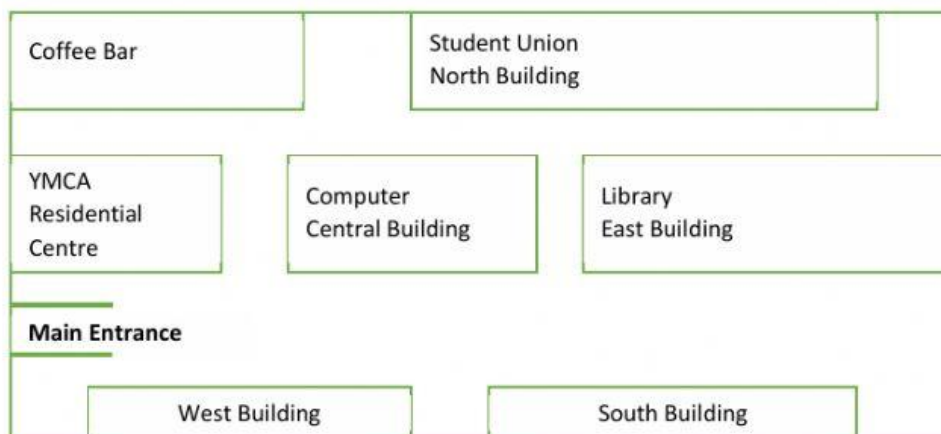

**Task 2.** Listen to the conversation again and list the places the student went to, and then write the reasons the student went to these places. (NO MORE THAN THREE WORDS)

	Place	Reason
Example	West Building	To register
	1. ....	.....
	2. ....	.....
	3. ....	.....
	4. ....	.....

<sup>41</sup> Tham khảo Exercise 14, Unit 3, Page 57, Listening strategies for the IELTS test

**Exercise 2. Label the map using the buildings below (File 5)**

A - Campus bookshop

C - Administration office

B - Registration Office

D - Student cafeteria

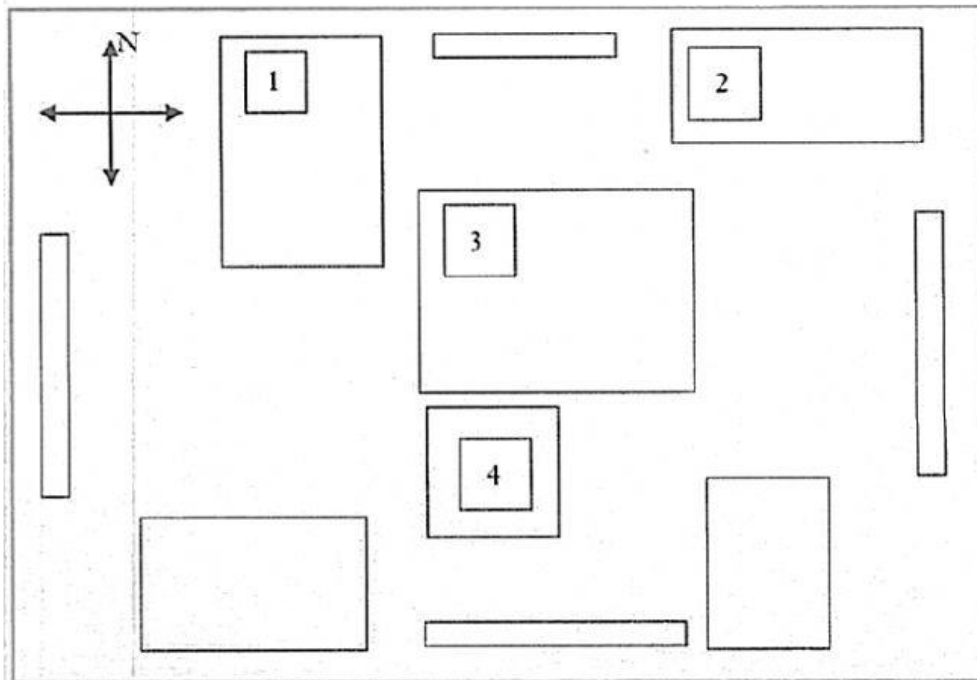

**Exercise 3. Listen to the tape and fill in with the missing words (File 6)**

**M=Male student**

**F=Female student**

M: Hi, could you tell me how to get to the Hall of Residence?

F: Yeah, go to the 1. .... of this building in front of you, walk straight 2. .... and it's the first on the right.

M: Excuse me, where is the Science Department?

F: You need to go right, take the 3. .... on the right and it's the second building on the left.

M: Can you help me? I'm trying to find the Library.

F: Go to the 4. .... of the garden. Turn left, and walk straight ahead. It's the second building on the right hand side. It's really big, you can't miss it.

M: I'm sorry to bother you. Where is the Refectory?

F: Okay, turn left here past the garden. Turn right and it's the 5. .... building on the left.

**Exercise 4<sup>42</sup>. You are going to a talk about the Student Union. As you listen, fill in the gaps in the notes below (File 7)**

All 1. .... students automatically belong to the Student Union and have full 2. .... and membership rights. Part-time students also have 3. .... to what the Union has to offer. Further details of this are available from the Student Union offices. The Union is affiliated to the NUS, which represents student on a 4. .... level. Student can take advantage of 5. .... travel facilities and a wide range of reductions on 6. .... goods, through the Student 7. .... Card.

**Indicate whether the following statements are true or not by writing**

*T for a statement which is true*

*F for a statement which is false*

*? if there is insufficient information*

8. The talk gives an introduction to the Student Union.
9. The Social Committee is responsible for entertainment on campus.
10. The Student Union finances all the clubs and societies at college.

---

<sup>42</sup> Tham khảo Exercise 12, Unit 5, Page 94, Listening Strategies for the IELTS test