

ESCOLA: classe 08 de Brazlândia DATA: 03/05/2021

ALUNO(A):

OBSERVE A PALAVRA:



LETRA INICIAL:

QUANTAS LETRAS:

LETRA FINAL:

QUANTAS SÍLABAS:

VEJA O FORMATO QUE A BOCA FAZ QUANDO FALAMOS A LETRA Z:



MARQUE AS GRAVURAS QUE COMEÇAM COM A LETRA Z.

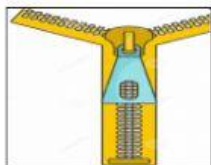

COMPLETE COM AS SÍLABAS ZA, ZE, ZI, ZO, ZU.

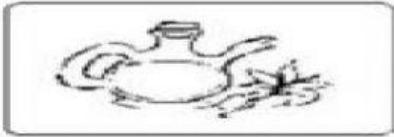

A _ _ _ ITE

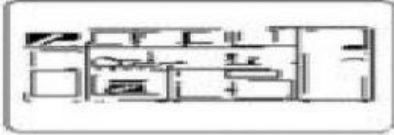

CO _ _ _ NHA



DO _ _ _



A _ _ _ LEJO