

NAMA :

KELAS :

PRACTICE

CHOOSE THE CORRECT ANSWER (PILIH JAWABAN YANG BENAR)

Tujuan : Menerapkan penggunaan kata depan (Beside & Behind) berdasarkan posisi pada denah rumah.

Look at the floor plan below and check (✓) the answer you think is correct! Lihatlah denah rumah di bawah dan berilah tanda centang (✓) pada jawaban yang menurut Anda benar.

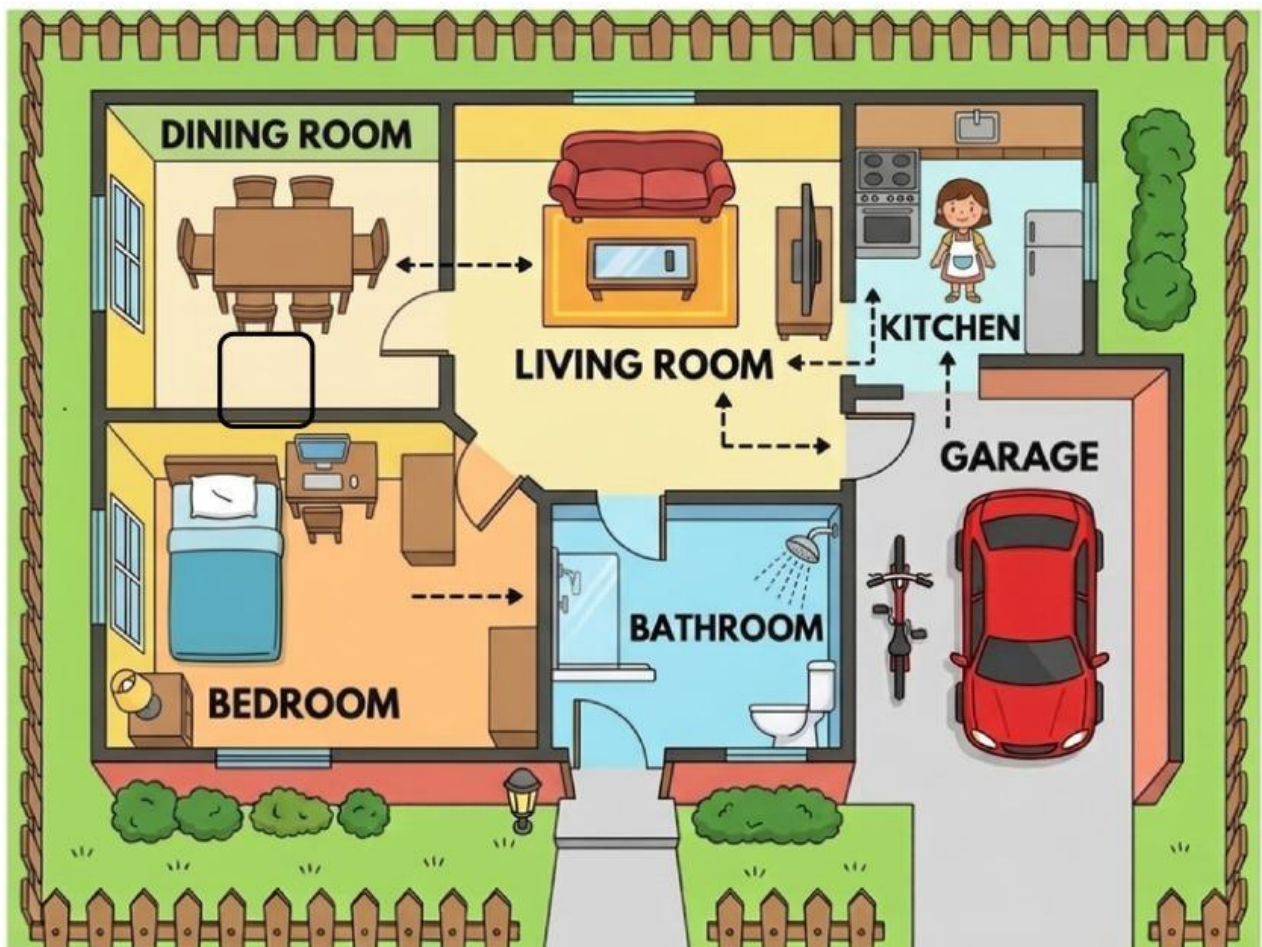

1. Where is the bedroom? it isthe living room

- Beside
- Behind

2. Where is the living room?.....the bathroom

- Beside
- Behind

3. Look! The bathroom is.....the kitchen.

- Beside
- Behind

4. The garage is.....the house.

- Beside
- Behind

5. Where is the dining room?.....the bedroom

- Beside
- Behind

NILAI :
