

# ROAD TO IELTS

IELTS preparation and practice



**Listening**  
Practice test 4

Candidate Number

Candidate Name \_\_\_\_\_

**INTERNATIONAL ENGLISH LANGUAGE TESTING SYSTEM****Listening****PRACTICE TEST**

1 hour

**Time** 1 hour**INSTRUCTIONS TO CANDIDATES**

Do not open this question paper until you are told to do so.

**Write your name and candidate number in the spaces at the top of this page.**

Listen to the instructions for each part of the paper carefully.

Answer all the questions.

While you are listening, write your answers on the question paper.

You will have 10 minutes at the end of the test to copy your answers onto the separate answer sheet. Use a pencil.

At the end of the test, hand in this question paper and your answer sheet.

**INFORMATION FOR CANDIDATES**

There are **four** parts to the test.

You will hear each part **once** only.

There are **40** questions.

Each question carries one mark.

For each part of the test, there will be time for you to look through the questions and time for you to check your answers.

## SECTION 1 Questions 1–10

Complete the notes below.

Write **NO MORE THAN TWO WORDS AND/OR A NUMBER** for each answer.

### BUYING A USED CAR

Example	Answer
Name of caller	Peter Smith

#### Vehicle Details:

- Vehicle for sale: 2012 Toyota sedan
- Vehicle colour: **1** .....
- Condition of vehicle: original **2** .....
  - no scratches
  - no dents
  - engine: no problems, regular servicing
- Ownership: one driver, old lady  
**3** .....
- Tyres: back tyres: worn  
front tyres: **4** .....
- Extras
  - air conditioning
  - 5** .....
  - power steering, central locking, ABS brakes
  - manual transmission
  - tow bar – useful for Peter's **6** .....
- Mileage: **7** ..... km

#### Meeting Arrangements

- Tina's address: **8** 352 .....
- Time of appointment: **9** ..... today
- Peter's phone number: **10** 045 -.....

**SECTION 2**

Questions 11–20

Questions 11–17

Label the plan below.

Write the correct letter, **A–I**, next to questions 11–17.

***Daisy Day Care Centre***

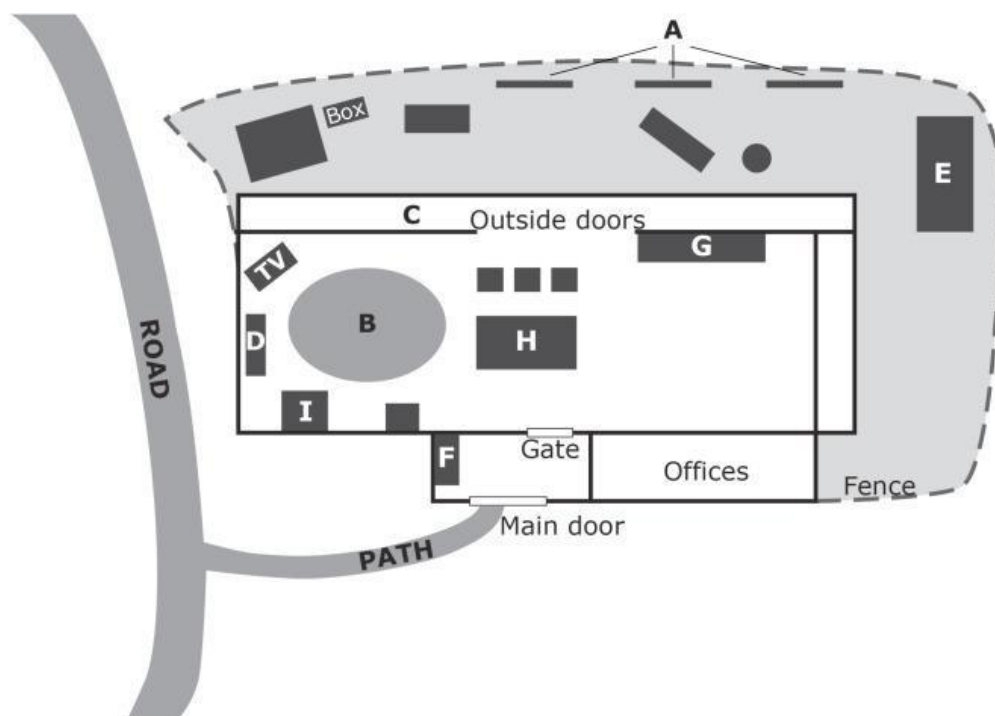

- |    |                   |       |
|----|-------------------|-------|
| 11 | shoe rack         | ..... |
| 12 | carpet            | ..... |
| 13 | bookcase          | ..... |
| 14 | dress-up cupboard | ..... |
| 15 | cubbyholes        | ..... |
| 16 | climbing walls    | ..... |
| 17 | chickens          | ..... |

Questions 18–20

Complete the sentences below.

Write **NO MORE THAN ONE WORD AND/OR A NUMBER** for each answer.

- 18 The official ratio of adults to children who are two or older is one adult to ..... children.
- 19 Parents who are often late may be asked to .....
- 20 The quickest waiting time for a place in the Day Care is .....



**SECTION 3**      Questions 21–30

Questions 21 and 22

Choose **TWO** letters, **A–E**

Professor Jones thinks that Mark will ask for more time for his essay because:

- A** two other students have already asked her
- B** her students never plan their assignments
- C** most students have handed in their assignments
- D** it is the day before the assignment is due in
- E** Mark is always late with his assignments

Questions 23–25

Choose **ONE** letter, **A, B or C**

**23** Mark needs an extension because:

- A** he was sick and went to the doctor
- B** he had a problem with his computer
- C** his brother had a personal problem

**24** Mark didn't come to see Professor Jones a week ago because:

- A** he thought his writing was very bad
- B** he planned to finish the essay on time
- C** he wanted to keep his grade point average

**25** Which rule below is NOT correct? You should

- A** ask at least 3 days before the essay is due
- B** fill out a form and then email it
- C** talk to your teacher in person

Questions 26–30

Complete the notes below.

Write **NO MORE THAN TWO WORDS AND/OR A NUMBER** for each answer.

**Professor Jones's feedback:**

- Mark needs to add **26** ..... to his bibliography
- He should look in the online databases, e.g. LanguageLine
- His essay has no **27** .....
- Mark plans to explain the theories and show **28** ..... for each of them
- He should **29** ..... the essay before he hands it in
- He can have one **30** ..... for his assignment

**SECTION 4**

## Questions 31–40

Questions 31–35

Complete the summary below.

Write **NO MORE THAN TWO WORDS AND/OR A NUMBER** for each answer.

### Managing Creativity in Your Business

Managing creative staff is a difficult task. They have creativity and **31** ....., so they need freedom. In the past, in factories, **32** ..... was vital for making a high quality product. Nowadays, we hire staff to create new products and find new customers. But, their new ideas must be **33** ..... if we want to make money from them. A standard method for managing staff is setting **34** ..... targets, related to profits, products or new clients. This method has some problems, because staff might be dishonest or break the law so that they can meet the company goals. These goals are often tied in to **35** ..... and this can make the problem worse.



Questions 36–40

Complete the table below.

Write **NO MORE THAN TWO WORDS** for each answer.

<b>Robert Simons' Three 36 .....</b>	
<p><b>The first:</b></p> <p>Engage the workers with the company's core values</p>	<p>Develop a mission statement</p> <p>Follow the company <b>37</b> .....</p> <p>examples:</p> <p>the best tools in the world</p> <p>the customer is no 1</p>
<p><b>The second:</b></p> <p>The power of <b>38</b> .....</p>	<p>Don't tell your creative staff what to do;</p> <p>tell them what they should <b>not</b> do, e.g.</p> <p>this product is not part of our company goals</p> <p>this behaviour is not OK</p> <p>You need to set <b>39</b>..... to help control creativity</p>
<p><b>The third:</b></p> <p><b>40</b>.....</p>	<p>Be aware of and discuss external factors</p> <p>the competition</p> <p>the company profits and losses</p> <p>other new products in the market</p>