

# IELTS PRACTICE TEST

## LISTENING

### Section 1

#### Questions 1-7

 **2.39** Complete the form below.

Write **NO MORE THAN TWO WORDS AND/OR A NUMBER** for each answer.

Temporary Employment Registration Form	
Category:	0 <u>full-time</u> employment
Name:	1 _____
Address:	2 _____ Avenue
Postcode:	3 _____
Contact number:	4 _____
Current situation:	studying 5 _____ at university
Availability:	July-September
Experience:	retail: assistant in a 6 _____ catering: worked as a 7 _____

#### Questions 8-10

 **2.40** Complete the notes below.

Write **NO MORE THAN TWO WORDS** for each answer.

POSSIBLE JOBS
• <u>Café</u> position of assistant might include 8 _____
• <u>Tourist information office</u> doing administrative work 9 _____ needed
• <u>Department store</u> serving in the 10 _____ department

## Section 2

### Questions 11-15

**2.41** Complete the table below.

Write **NO MORE THAN TWO WORDS** for each answer.

Parents' Evening - Talks		
Time	Speaker	Topics
7.00-7.30	head teacher	- tests in the future - the latest 11 .....
7.30-7.45	deputy head teacher	- changes at 12 .....
7.45-8.00	a 14 .....	- school trips during the year - 15 ..... the children will use

### Questions 16-20

**2.42** Label the plan of part of the school below.

Write the correct letter, **A-H**, next to questions 16-20.

AREA OF SCHOOL USED FOR PARENTS' EVENING

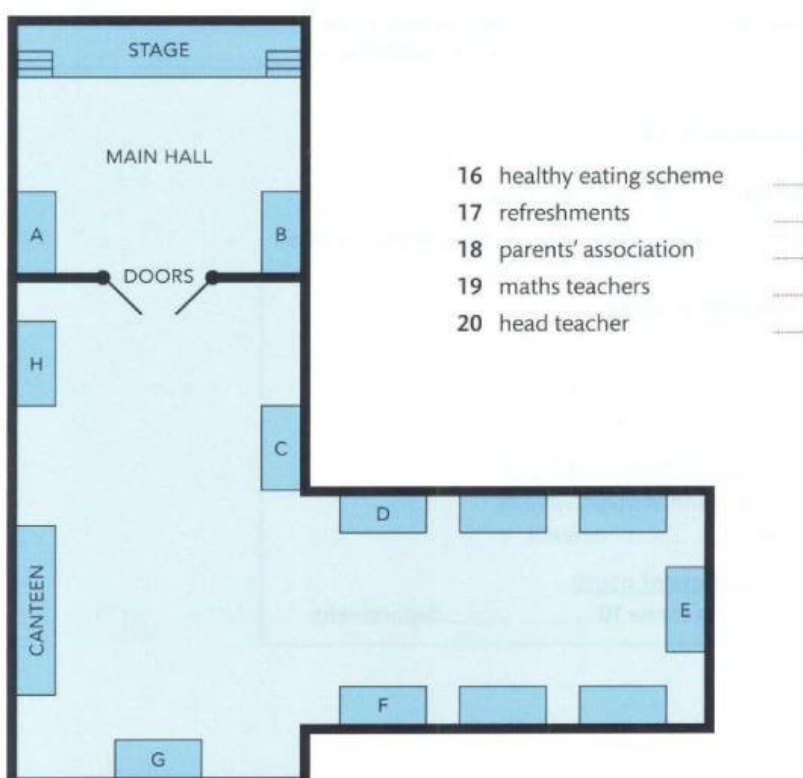

## Section 3

### Questions 21–24

 **2.43** What surprised the speakers when they were doing their research?

Write the correct letter, **L**, **H**, **B** or **N** next to questions 21–25.

Write

**L** if Liam only was surprised

**H** if Holly only was surprised

**B** if Both of them were surprised

**N** if Neither of them was surprised

- 21 the paper's sales figures
- 22 the paper's response to the arrival of the internet
- 23 the amount of influence the paper has had
- 24 the cartoons in the paper in the past

### Questions 25–27

 **2.44** Choose **THREE** letters, **A–F**.

Which **THREE** features of the paper have stayed the same according to the speakers?

- A its political views
- B its weather reports
- C its coverage of famous people
- D its sports section
- E its handling of social issues
- F its appearance

### Questions 28–30

 **2.45** Choose the correct letter, **A**, **B** or **C**.

- 28 In the general section, Liam is going to focus on
  - A why British people choose to read a particular newspaper.
  - B how British people judge other readers of newspapers.
  - C what gives each newspaper its reputation.
- 29 In the general section, Holly is going to discuss
  - A why someone stops reading a particular newspaper.
  - B reasons for a decline in loyalty to newspapers.
  - C how newspapers change to appeal to new readers.
- 30 One reason why both speakers have enjoyed doing the project is that
  - A they could choose what to focus on.
  - B it has involved less work than other projects.
  - C they have learnt a lot about a single topic.

## Section 4

### Questions 31-34

2.46 Complete the summary below.

Write NO MORE THAN TWO WORDS for each answer.

## Short history of Tower Bridge

Before Tower Bridge was built, the only way to cross the river in that area was through Tower Subway, which was built in 1870. At first, Tower Subway had an 31 \_\_\_\_\_ but after three months it became a tunnel for people to walk through. To meet the demand for a new crossing, a committee was formed, and they used a 32 \_\_\_\_\_ to find the best design. A fixed bridge could not be used because 33 \_\_\_\_\_ ships had to go through it, so a bridge was created with 'bascules'. These were two sections that would separate when they were 34 \_\_\_\_\_ so the ships could pass.

### Questions 35-37

2.47 Label the diagram below.

Write NO MORE THAN TWO WORDS for each answer.

#### HOW TOWER BRIDGE WAS RAISED

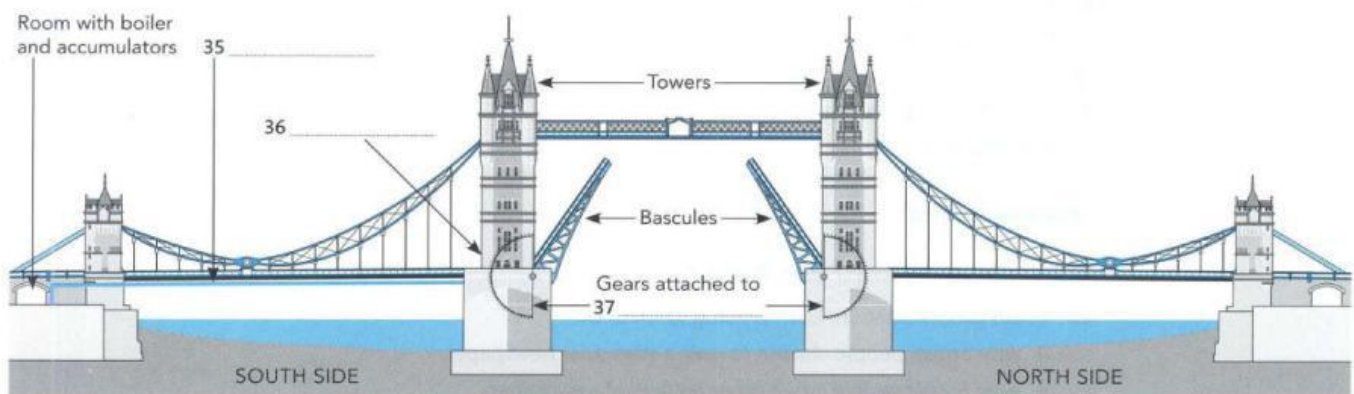

### Questions 38-40

2.48 Complete the sentences below.

Write NO MORE THAN TWO WORDS AND/OR A NUMBER for each answer.

- 38 During the day, \_\_\_\_\_ were placed on the bridge to signal to ships.
- 39 During the day, ships were required to have a \_\_\_\_\_ in a high position.
- 40 Nowadays, ships have to notify the bridge \_\_\_\_\_ before they want to pass through it.