

IELTS Practice Listening Test

(ref: IELTS.L16.ee)

Section 1. Questions 1-10. Complete the notes below. Write **NO MORE THAN ONE WORD AND/OR A NUMBER** for each answer.

Enquiry about joining Youth Council

Name: Roger Brown

Age: 18

- 1 Currently staying in a _____ during the week
- 2 Postal address: 17 _____ Street, Stamford, Lincs
- 3 Postcode: _____
- 4 Occupation: student and part-time job as a _____
- 5 Studying _____ (major subject) and history (minor subject)
- 6 Hobbies: does a lot of _____, and is interested in the
7 _____
- 8 On Youth Council, wants to work with young people who are _____
Will come to talk to the Elections Officer next Monday at
9 _____ pm
- Mobile number: 10 _____

Section 2. Questions 11-16. Choose **TWO** letters, A – E.

11/12 Which **TWO** changes have been made so far during the refurbishment of the theatre?

- A Some rooms now have a different use.
- B A different type of seating has been installed.
- C An elevator has been installed.
- D The outside of the building has been repaired.
- E Extra seats have been added.

13/14 Which **TWO** facilities does the theatre currently offer to the public?

- A rooms for hire
- B backstage tours
- C hire of costumes
- D a bookshop
- E a café

15/16 Which **TWO** workshops does the theatre currently offer?

- A** sound
- B** acting
- C** making puppets
- D** make-up
- E** lighting

Questions 17-20. Label the plan below. Write the correct letter, A – G, next to Questions 17-20.

Theatre ground floor plan

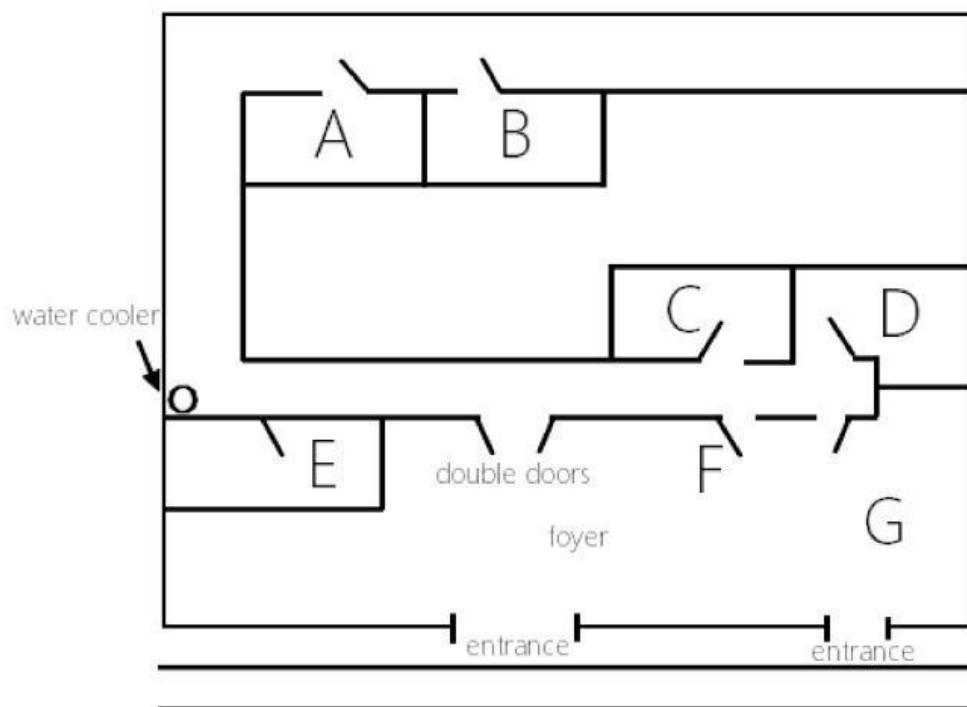

17 box office _____

18 theatre manager's office _____

19 lighting box _____

20 artistic director's office _____

Section 3. Questions 21-26. Choose the correct letter, **A**, **B** or **C**.

Rocky bay field trip

- 21** What do the students agree should be included in their aims?
- A** factors affecting where organisms live
 - B** the need to preserve endangered species
 - C** techniques for classifying different organisms
- 22** What equipment did they forget to take on the Field Trip?
- A** string
 - B** a compass
 - C** a ruler
- 23** In Helen's procedure section, Colin suggests a change in
- A** the order in which information is given.
 - B** the way the information is divided up.
 - C** the amount of information provided.
- 24** What do they say about the method they used to measure wave speed?
- A** It provided accurate results.
 - B** It was simple to carry out.
 - C** It required special equipment.
- 25** What mistake did Helen make when first drawing the map?
- A** She chose the wrong scale.
 - B** She stood in the wrong place.
 - C** She did it at the wrong time.
- 26** What do they decide to do next with their map?
- A** scan it onto a computer
 - B** check it using photographs
 - C** add information from the Internet

Questions 27, 28. Choose **TWO** letters, A – E.

Which **TWO** problems affecting organisms in the splash zone are mentioned?

- A** lack of water
- B** strong winds
- C** lack of food
- D** high temperatures
- E** large waves

Questions 29, 30. Choose **TWO** letters, A – E.

Which **TWO** reasons for possible error will they include in their report?

- A** inaccurate records of the habitat of organisms
- B** influence on behaviour of organisms by observer
- C** incorrect identification of some organisms
- D** making generalisations from a small sample
- E** missing some organisms when counting

Section 4. Questions 31-40. Complete the notes below. Use **ONE WORD ONLY** for each answer.

DESIGNING A PUBLIC BUILDING: THE TAYLOR CONCERT HALL

Introduction

The designer of a public building may need to consider the building's

- function
- physical and **31** _____ context
- symbolic meaning

Location and concept of the Concert Hall

On the site of a disused **32** _____

Beside a **33** _____

The design is based on the concept of a mystery

Building design

It's approached by a **34** _____ for pedestrians

The building is in the shape of a **35** _____

One exterior wall acts as a large **36** _____

In the auditorium

- the floor is built on huge pads made of **37** _____
- the walls are made of local wood and are **38** _____ in shape
- ceiling panels and **39** _____ on walls allow adjustment of acoustics

Evaluation

Some critics say the **40** _____ style of the building is inappropriate.