

1. Which is the best feature used for this?

- A. Sweep
- B. Revolves
- C. Loft



2. Which is the best feature used to make this?

- A. Sweep
- B. Revolves
- C. Loft



3. What is the best feature to make this?

Sweep    Loft    Revolve    Extrude

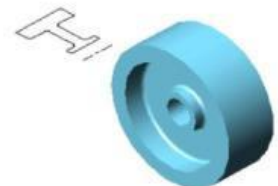

4. Which of the following can be used to draw arcs (curved lines with specific radius)?

