

HOMEWORK TEST PREP 10

LISTENING

SECTION 1 Questions 1-10

Complete the notes below.

Write *ONE WORD AND/OR A NUMBER* for each answer.

Enquiry about joining Youth Council

Example

Name: Roger.....Brown

Age: 18

Currently staying in a 1 during the week

Postal address: 2 17, Street, Stamford, Lincs

Postcode: 3

Occupation: student and part-time job as a 4

Studying 5 (major subject) and history (minor subject)

Hobbies: does a lot of 6 , and is interested in the

7

On Youth Council, wants to work with young people who are
8

Will come to talk to the Elections Officer next Monday at
9 pm

Mobile number: 10

SECTION 2 Questions 11-20

New staff at theatre

Questions 11 and 12

Choose **TWO** letters, A-E.

Which **TWO** changes have been made so far during the refurbishment of the theatre?

- A Some rooms now have a different use.
- B A different type of seating has been installed.
- C An elevator has been installed.
- D The outside of the building has been repaired.
- E Extra seats have been added.

Questions 13 and 14

Choose **TWO** letters, A-E.

Which **TWO** facilities does the theatre currently offer to the public?

- A rooms for hire
- B backstage tours
- C hire of costumes
- D a bookshop
- E a cafe

Questions 15 and 16

Choose **TWO** letters, A-E.

Which **TWO** workshops does the theatre currently offer?

- A sound
- B acting
- C making puppets
- D make-up
- E lighting

Questions 17-20

Label the plan below.

Write the correct letter, A-G, next to Questions 17-20.

Ground floor plan of theatre

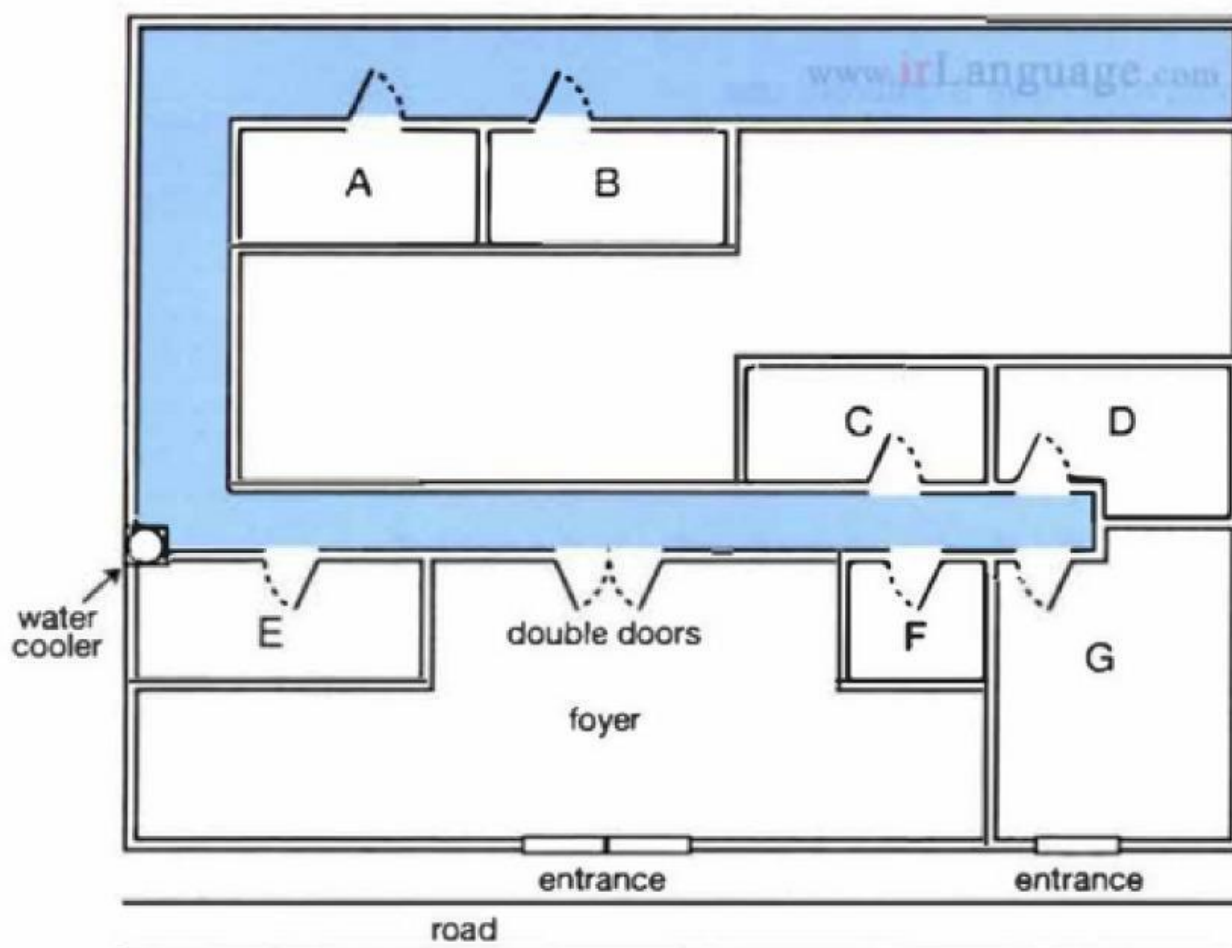

- 17 box office theatre
- 18 manager's office
- 19 lighting box artistic
- 20 director's office

SECTION 3 Questions 21-30

Questions 21-26 Choose the correct letter, *A*, *B* or *C*.

Rocky Bay field trip

- 21 What do the students agree should be included in their aims?
- A factors affecting where organisms live
 - B the need to preserve endangered species
 - C techniques for classifying different organisms
- 22 What equipment did they forget to take on the Field Trip?
- A string
 - B a compass
 - C a ruler
- 23 In Helen's procedure section, Colin suggests a change in
- A the order in which information is given.
 - B the way the information is divided up.
 - C the amount of information provided.
- 24 What do they say about the method they used to measure wave speed?
- A It provided accurate results.
 - B It was simple to carry out.
 - C It required special equipment.
- 25 What mistake did Helen make when first drawing the map?
- A She chose the wrong scale.
 - B She stood in the wrong place.
 - C She did it at the wrong time.
- 26 What do they decide to do next with their map?
- A scan it onto a computer
 - B check it using photographs
 - C add information from the internet

Questions 27 and 28

Choose **TWO** letters, **A–E**.

www.irlanguage.com

Which **TWO** problems affecting organisms in the splash zone are mentioned?

- A** lack of water
- B** strong winds
- C** lack of food
- D** high temperatures
- E** large waves

Questions 29 and 30

Choose **TWO** letters, **A–E**.

Which **TWO** reasons for possible error will they include in their report?

- A** inaccurate records of the habitat of organisms
- B** influence on behaviour of organisms by observer
- C** incorrect identification of some organisms
- D** making generalisations from a small sample
- E** missing some organisms when counting

SECTION 4 Questions 31-40

Complete the notes below.

Write **ONE WORD ONLY** for each answer.

DESIGNING A PUBLIC BUILDING: THE TAYLOR CONCERT HALL

Introduction

The designer of a public building may need to consider the building's

- function
- physical and **31** context
- symbolic meaning

Location and concept of the Concert Hall

On the site of a disused **32**

Beside a **33**

The design is based on the concept of a mystery

Building design

It's approached by a **34** for pedestrians

The building is the shape of a **35**

One exterior wall acts as a large **36**

In the auditorium:

- the floor is built on huge pads made of **37**
- the walls are made of local wood and are **38** in shape
- ceiling panels and **39** on walls allow adjustment of acoustics

Evaluation

Some critics say the **40** style of the building is inappropriate