

MODULE

6

Getting around

PBD
1

Listening

SOW: Lesson 81

Textbook: p 59



A Listen and write. LS 1.1.1

Look left, look right
Wait for the (1)
To change from red to green.
Be cool, be great
Stop. (2) (3) Wait.
When you cross the (4)

Walk on the (5)
When you're in town.
Keep safe, be cool
Always look around
Fasten your (6)
When you're in a car.
Keep safe, be cool
You're a (7)

At the (8)
Wait for the cars to stop.
Keep safe, be cool
When you go to the (9)
Put on the (10)
When you're on a bike.
Oh! It's windy
Hold on (11)

| | |
|---------------|----------------|
| tight | pavement |
| road | zebra crossing |
| superstar | seat belt |
| shop | listen |
| traffic light | look |
| helmet | |

B Find the rhyming words from the poem.

1. car

2. light

3. shop



Grammar Drill

Imperatives

We use an imperative to express a command.

Examples:

- (a) Wash the dishes. (Affirmative form)
(b) Don't stick your head out of the window. (Negative form)

Fill in the safety rules. **LS 2.1.3**



Safety rules

In the street

On the bike

Wear a helmet.

Use the pedestrian bridge.

Use hand signals for turning.

Look both ways before you cross the road.

Cycle in single file.

Don't use mobile phones while driving.

Walk on the pavement.

Wear bright clothing when you cycle at night.

Questions

1. We use 'what time' or 'how long' when we're asking about time.
2. 'how' means 'in what way' or 'by what methods'.

Read and answer the questions that follow. **LS 3.2.2**



Hi, Anis. Tomorrow is Saturday. Do you have any plans?

Hi, Yati. I'm going to go to the **theme park** with my siblings.

Wow! That's great. I'm sure you'll have lots of fun. How are you going to get there?

By LRT. There's a direct train from the station near my house.

What time does the train leave?

The train leaves at 9.10 in the morning. The journey will take about 30 minutes.

Name:

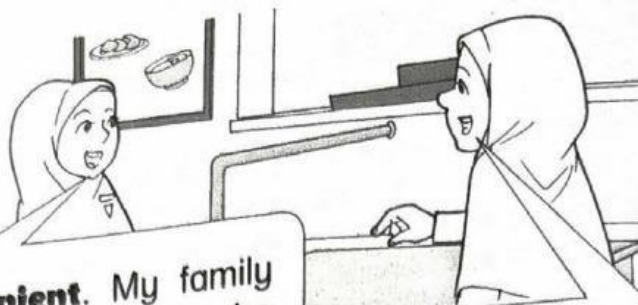

That's pretty **convenient**. My family and I are going to visit my aunt who lives in a fishing village. My dad is going to drive us there.

Your trip sounds exciting. Let's **catch up** on our trip when we meet on Monday.



Word Guide

theme park: taman tema

convenient: sesuai

catch up: berbincang

1. How is Anis going to get to the theme park?
A By car
B On foot
C By train
2. How long does it take to reach the theme park?
A An hour
B Half an hour
C One hour and thirty minutes
3. Where are Yati and her family going to go?
A An island
B A fishing village
C An amusement park
4. How are Yati and her family going to get there?
A By car
B By bus
C By plane
5. When will Yati and Anis meet again?
A On Monday
B On Tuesday
C On Thursday

LS 3.2.2 Performance Level 1 2 3 4 5 6

A Listen. For each question, choose the correct answer. **LS 1.2.2** **LS 1.2.5**

1. How does Mr Brown go to work?

A By car

B By train

C On foot

2. What time does he go to work every morning?

A 7.30

B 8.00

C 8.30

3. Where is the train station?

A In front of his flat

B In front of his office

C Between his office and his flat

4. How long does it take to get to his office?

A 15 minutes

B 30 minutes

C 60 minutes

5. What time does he go home?

A 6:00

B 7:00

C 8:00



B Listen and complete the table.

| | |
|-------------|--|
| Date | |
| Trip to | |
| Going by | |
| I leave at | |
| I arrive at | |





Grammar Drill

A gerund acts like a noun.

Example: **Smoking** is bad for health.

Gerund

Look and write. LS 4.2.3

1.



– school – bus – every morning – travelling – comfortable

I go to _____ every morning.

Travelling by _____.

2.

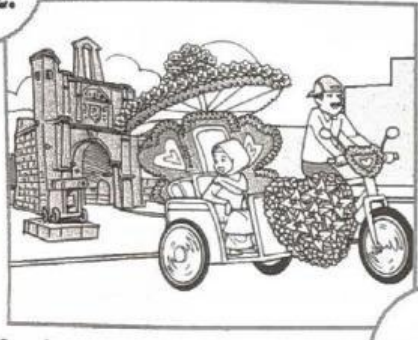

– ride – trishaw – explore – town – riding – slow

I ride _____ to _____.

_____ Riding in _____.

3.

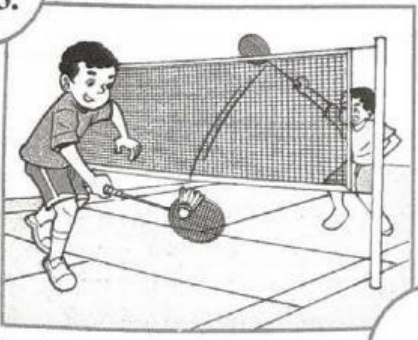

– play badminton – leisure time – playing – fun

4.



– ride – snowmobile – snow – riding – exciting

Name:

Class:

PBD
7

Speaking

SOW: Lesson 92

Textbook: p 65

Arrange the steps in correct order.

LS 2.2.2

LS 2.1.3

I THINK

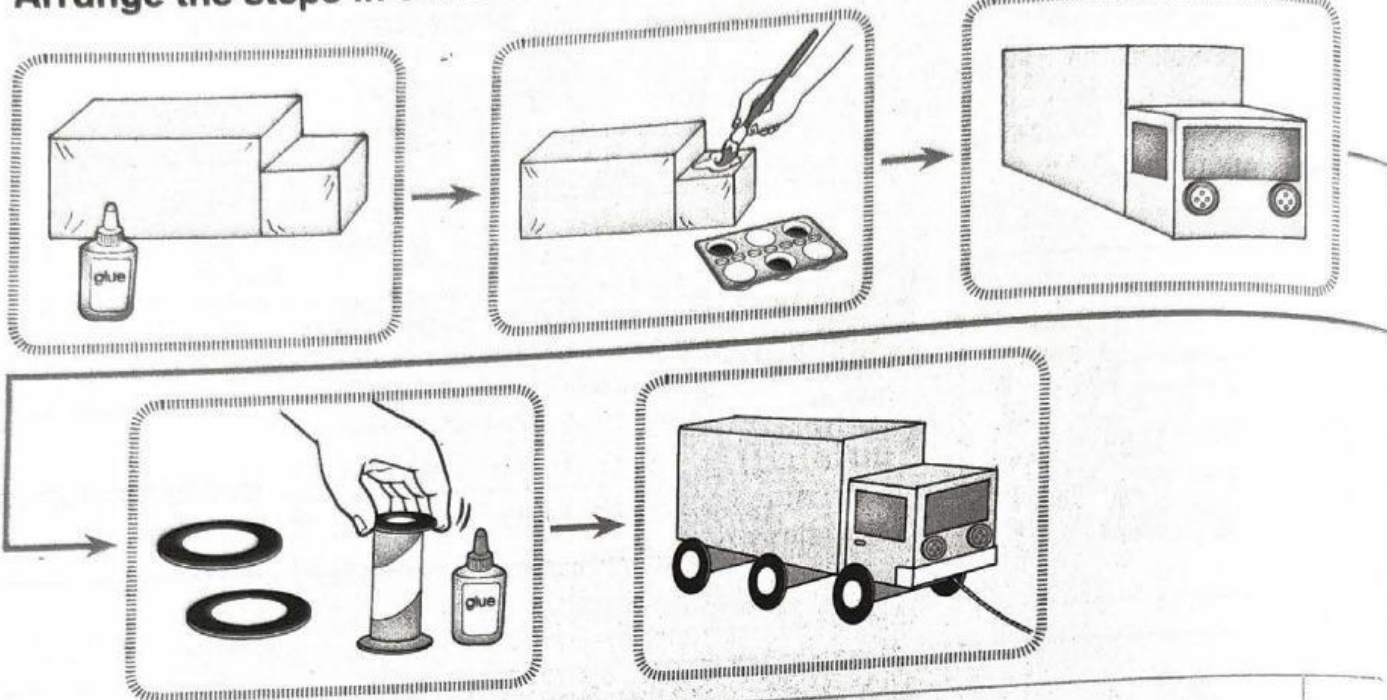

Paint the vehicle with your preferred colour.

Make wheels by drawing and cutting out circles from black-coloured paper.

Get a big box and a small box. Glue the two boxes together.

Use glue to attach the wheels at the bottom of the vehicle.

Cut out rectangles and glue them on as windows. Glue buttons on as headlights.

Module 6

Getting around