

PART 1

Questions 1-5. Choose the correct answer: A, B or C.

1 What is the caller's surname?

A Fleischer

B Fischer

C Bennett

2 The caller says the correct colour of his car is

A Sky blue

B Light green

C White

3 What time does the caller say he went to collect his car?

A 9:30pm

B 8pm

C 8:30pm

4 Where does the caller usually store the front panel of his radio?

A In his pocket

B The hospital

C In the glove compartment

5 What does the advisor say she will send through the mail to the caller?

A A radio

B Some CDs

C Some forms

Questions 6-10

Complete the notes below.

Write **NO MORE THAN TWO WORDS AND/OR A NUMBER** for each answer.

Insurance Claim Report

CUSTOMER FIRST NAME: Bennett

POLICY NUMBER: 6.....

TYPE OF CLAIM: Stolen 7.....

PLACE WHERE OFFENCE WAS REPORTED: York 8..... Station

CUSTOMER AWARE OF THE DANGER: No

OTHER ITEMS STOLEN: Car radio, CDs and an old 9.....

DOCUMENTS REQUESTED TO SUPPORT CLAIM: Police report and 10.....

PART 2

Questions 11-13. Complete the sentences below.

Write **ONE WORD ONLY** for each answer.

11 There are two entrances to the

12 The first section you enter when leaving the staff room is the

13 The pass through the dungeons as a group.

Questions 14-18

Complete the labels on the map.

Write **NO MORE THAN TWO WORDS** for each answer

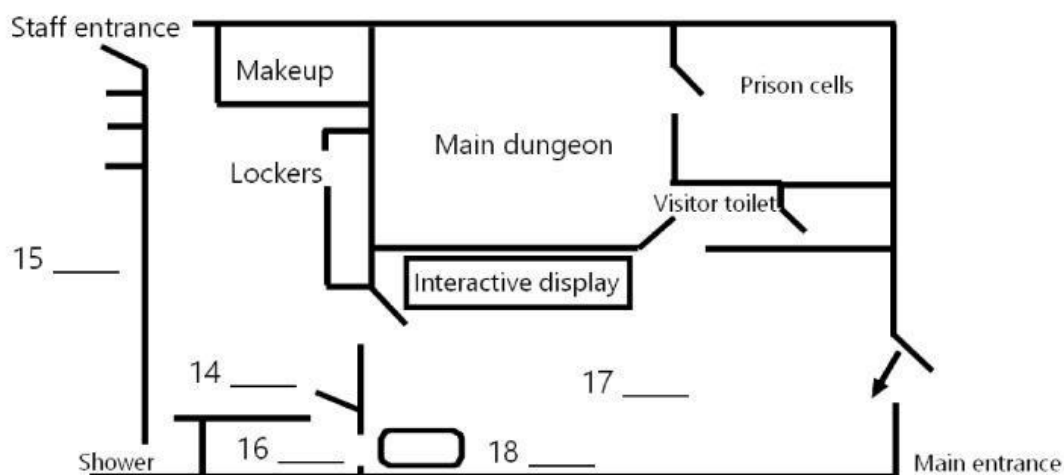

14.....

18.....

15

16.....

17.....

Questions 19, 20

Choose **TWO** letters, A-E.

What are **TWO** things the speaker suggests the employees should do to help visitors?

- A help to carry their bags
- B guide them if they have gone the wrong way
- C talk to them in a strange accent
- D scare them so they have a more authentic experience
- E answer any questions they might have

Section 3

Questions 21-26

Choose the correct letter, **A**, **B** or **C**.

Rocky bay field trip

21 What do the students agree should be included in their aims?

- A factors affecting where organisms live
- B the need to preserve endangered species
- C techniques for classifying different organisms

22 What equipment did they forget to take on the Field Trip?

- A string
- B a compass
- C a ruler

23 In Helen's procedure section, Colin suggests a change in

- A the order in which information is given.
- B the way the information is divided up.
- C the amount of information provided.

24 What do they say about the method they used to measure wave speed?

- A It provided accurate results.
- B It was simple to carry out.
- C It required special equipment.

25 What mistake did Helen make when first drawing the map?

- A** She chose the wrong scale.
- B** She stood in the wrong place.
- C** She did it at the wrong time.

26 What do they decide to do next with their map?

- A** scan it onto a computer
- B** check it using photographs
- C** add information from the Internet

Questions 27, 28

Choose **TWO** letters, **A – E**.

Which **TWO** problems affecting organisms in the splash zone are mentioned?

- A** lack of water
- B** strong winds
- C** lack of food
- D** high temperatures
- E** large waves

Questions 29, 30

Choose **TWO** letters, **A – E**.

Which **TWO** reasons for possible error will they include in their report?

- A** inaccurate records of the habitat of organisms
- B** influence on behaviour of organisms by observer
- C** incorrect identification of some organisms
- D** making generalisations from a small sample
- E** missing some organisms when counting

Section 4

Questions 31-40

Complete the notes below.

Use **ONE WORD ONLY** for each answer.

DESIGNING A PUBLIC BUILDING: THE TAYLOR CONCERT HALL

Introduction

The designer of a public building may need to consider the building's

- function
- physical and **31**..... context
- symbolic meaning

Location and concept of the Concert Hall

On the site of a disused **32**.....

Beside a **33**.....

The design is based on the concept of a mystery

Building design

It's approached by a **34**..... for pedestrians

The building is in the shape of a **35**.....

One exterior wall acts as a large **36**.....

In the auditorium

- the floor is built on huge pads made of **37**.....
- the walls are made of local wood and are **38**..... in shape
- ceiling panels and **39**..... on walls allow adjustment of acoustics

Evaluation

Some critics say the **40**..... style of the building is inappropriate