

Listening

Duration: 30 minutes

SECTION 1 Questions 1–10

Questions 1–7

Complete the form below.

Write **NO MORE THAN TWO WORDS** for each answer.

Write your answers in boxes 1–7 on your answer sheet.

CLINIC REGISTRATION FORM

Example

Name: Alan Macfee

Date of birth: 24/8/1972
Present address: Flat A,
37, 1 _____ House
Plympton
PL7 8BH
Contact phone number: 0774376521
Current occupation: 2 _____

General health

Special needs: Partially 3 _____
Current medications: None
Medical history (last 12 months)
A stay in 4 _____ (June, one day)
Injury: a 5 _____

Additional notes

Requested patient should bring in: - a 6 _____ (recent)
- one 7 _____ (e.g. water)

Questions 8–10

Choose the correct letter **A**, **B** or **C**.

Write your answers in boxes 8–10 on your answer sheet.

- 8 When will Alan have his clinic appointment?
A Tuesday B Wednesday C Thursday
- 9 What transport does Alan decide to use to get to the clinic?
A own car B bus C taxi
- 10 Alan found out about the clinic from
A the Internet. B a list in the library. C a colleague.

SECTION 2 Questions 11–20

Science Fair

Questions 11–12

According to the speaker, what are the **TWO** reasons why the fair was first organised?

Choose **TWO** answers and write the correct letters **A–E** in boxes 11 and 12 on your answer sheet.

- A Science was well taught in local schools.
- B A local factory gave generous sponsorship.
- C Exam performance needed improvement.
- D Another fair stopped running.
- E A good site for the fair became available.

Questions 13–14

What **TWO** things do people often forget to include in their displays?

Choose **TWO** answers and write the correct letters **A–E** in boxes 13 and 14 on your answer sheet.

- A procedures followed
- B materials used
- C a summary of the whole project
- D conclusions drawn
- E photos of work in progress

Questions 15–16

What are the **TWO** biggest growth areas at the fair?

Choose **TWO** answers and write the correct letters **A–E** in boxes 15 and 16 on your answer sheet.

- A interactive displays
- B pre-school projects
- C energy conservation projects
- D the number of people attending
- E cutting-edge research projects

Questions 17–20

Label the plan below.

Where in the exhibition hall are the following places?

Write the correct letter, **A–I**, in boxes 17–20 on your answer sheet.

- 17 Registration
- 18 Gaming zone
- 19 Commercial displays
- 20 Video room

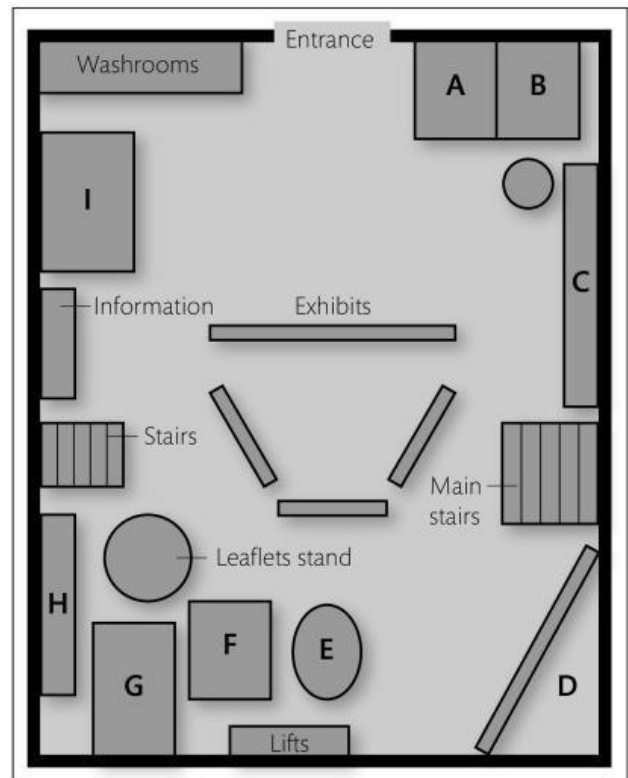

SECTION 3 Questions 21–30

The history of the word 'nice'

Questions 21–24

Choose the correct letter, **A**, **B** or **C**.

Write your answers in boxes 21–24 on your answer sheet.

21 Tom and Ruby choose to focus on the word 'nice' because

- A it has so many different usages.
- B it's so well known by many people.
- C its meaning has changed a lot over time.

22 What inspired Tom and Ruby to research the history of words?

- A thinking about the content of a novel
- B talking to classmates about their plans
- C listening to a particularly interesting lecture

23 What resource do Tom and Ruby agree they need to add to their presentation?

- A interview data
- B computer software
- C journal articles

24 What is Ruby most worried about the reading they have done for the presentation?

- A its relevance to the course
- B overlap with other modules
- C the date of references

Questions 25–30

What action do Tom and Ruby agree they will need to take for each part of their presentation?

Choose **SIX** answers from the box and write the correct letter, **A–I**, in boxes 25–30 on your answer sheet.

Agreed actions

- A act out a scene
- B make it longer
- C explain a selection of sample texts
- D get the audience to do a task
- E make it substantially shorter
- F consider omitting something if insufficient time
- G use some visuals
- H present some research findings
- I play an audio recording

Parts of presentation

- 25 Title
- 26 Introduction
- 27 Historical background
- 28 Current usage
- 29 Additional meanings
- 30 Future directions

SECTION 4 Questions 31–40

Threats to UK trees

Questions 31–32

According to the speaker, what **TWO** benefits of forests make them so important?

Choose **TWO** answers and write the correct letters **A–E** in boxes 31 and 32 on your answer sheet.

- A They provide a good return on investment.
- B They improve the health of the environment.
- C They give employment in local communities.
- D They produce numerous different commodities.
- E They provide recreational space for humans.

Questions 33–34

What **TWO** things prompted the speaker to choose the issue of tree loss for her presentation?

Choose **TWO** answers and write the correct letters **A–E** in boxes 33 and 34 on your answer sheet.

- A She saw the effects of an earlier tree disease.
- B She was worried by tree loss in her local area.
- C She learned of a serious new threat to UK trees.
- D She contributed to a recent research project.
- E She read a government publication.

Questions 35–36

What **TWO** things does the speaker feel will best help us tackle tree diseases?

Choose **TWO** answers and write the correct letters **A–E** in boxes 35 and 36 on your answer sheet.

- A understanding how different trees get the disease
- B reducing the amount of international trade
- C improving communication between scientists
- D involving the public in research initiatives
- E training more people to work in the forestry industry

Questions 37–40

Complete the table.

Write **ONE WORD ONLY** for each answer.

Write your answers in boxes 37–40 on your answer sheet.

Type of pest	Tree affected	Main means of spread	Knowledge gaps
Beetle (<i>Dendroctonus micans</i>) Origin: Eurasia	Spruce	- Import of logs - 37 _____ of adult beetles	Influence of changes in 38 _____
Moth (<i>Thaumetopoea processionea</i>) Origin: Central and Southern Europe	Oak	- Import of live saplings for 39 _____ e.g. in gardens - Material from tree cutting	- Biology of the moth e.g. timing of egg hatch - Best methods of 40 _____ movement