

Test 1

PAPER 1 READING AND WRITING (1 hour 10 minutes)

PART 1

QUESTIONS 1–5

Which notice (A–H) says this (1–5)?

For questions 1–5, mark the correct letter A–H on the answer sheet.

EXAMPLE	ANSWER
0 We can answer your questions.	E

- 1 You can't drive this way.
- 2 Children do not have to pay.
- 3 You can shop here six days a week.
- 4 Be careful when you stand up.
- 5 We work quickly.

- A

Adults £2.50
Under 12s FREE
- B

Shoes repaired while you wait
- C

MIND YOUR HEAD
- D

Open 24 hours a day
- E

INFORMATION
- F

Police Notice
Road Closed
- G

Open daily 10–6
(except Mondays)
- H

WAITING ROOM

PART 2

QUESTIONS 6–10

Read the sentences (6–10) about a birthday.

Choose the best word (A, B or C) for each space.

For questions 6–10, mark A, B or C on the answer sheet.

EXAMPLE	ANSWER
0 Nina up early that morning because it was her birthday. A stood B woke C came	B

- 6 Nina was very because she got lots of presents.
A interesting B lovely C happy
- 7 She some friends to her house for a party.
A decided B agreed C invited
- 8 Her mother made a big chocolate with 'Happy Birthday' on the top.
A meal B cake C dish
- 9 Nina and her friends had a great time, singing and dancing and to their favourite music.
A listening B hearing C looking
- 10 When they had to go, everybody Nina and her mother for the party.
A said B thanked C told

PART 6

QUESTIONS 36–40

Read the descriptions (36–40) of some words about holidays and travel.

What is the word for each description?

The first letter is already there. There is one space for each other letter in the word.

For questions 36–40, write the words on the answer sheet.

EXAMPLE	ANSWER
0 You can take photos of your holiday with this.	c a m e r a

- | | |
|---|-------------|
| 36 You need this to travel to some foreign countries. | p _ _ _ _ _ |
| 37 You need to buy this before you get on a plane. | t _ _ _ _ |
| 38 This is where you go to get a plane. | a _ _ _ _ |
| 39 You put your clothes in this when you travel. | s _ _ _ _ |
| 40 This person likes visiting different places. | t _ _ _ _ |

PART 7

QUESTIONS 41–50

Complete this letter.

Write ONE word for each space (41–50).

For questions 41–50, write your words on the answer sheet.

28 Long Road
Brighton

22nd March

Dear Pat,

I arrived (**Example:** here) three weeks ago. I'm studying at a language school 41 Brighton. The students come 42 many different countries and I 43 made a lot of new friends.

There 44 classes for five hours every day. I like 45 teacher very much. 46 name is John and he helps me 47 I make a mistake.

I want 48 visit London next weekend because I 49 going back to my country on Monday. Can I see you there? Please write to 50 soon.

With best wishes from

Maria

PAPER 2 LISTENING (approximately 30 minutes, including 8 minutes transfer time)

PART 1

QUESTIONS 1–5

You will hear five short conversations.

You will hear each conversation twice.

There is one question for each conversation.

For questions 1–5, put a tick ☒ under the right answer.

EXAMPLE

0 What time is it?



A ☐



B ☐



C ☒

1 What have they forgotten?

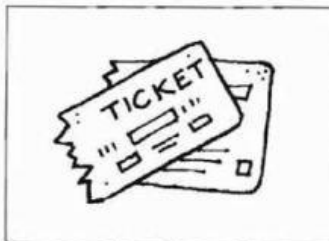

A ☐

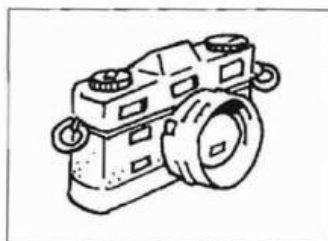

B ☐



C ☐

2 What time does the train go?

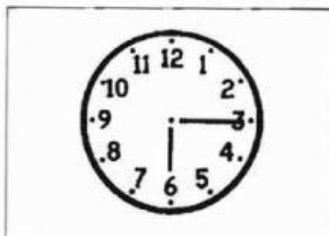

A ☐

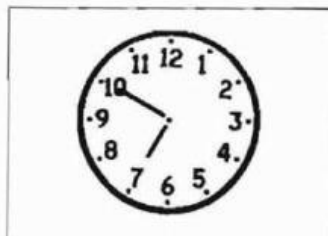

B ☐

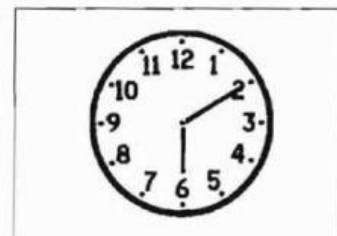

C ☐

3 Where is Room 22?

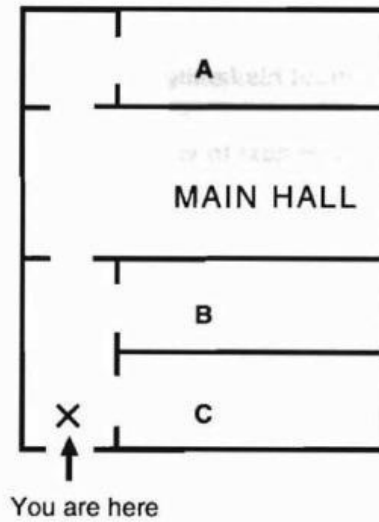

A ☐

B ☐

C ☐

4 Which man wants to see him?



A ☐



B ☐



C ☐

5 How did the woman get to work?

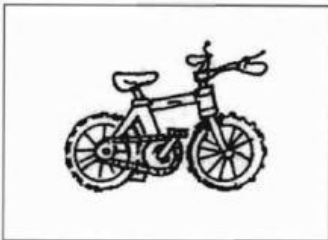

A ☐



B ☐

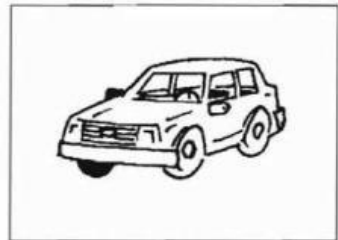

C ☐

Test 1

PART 2

QUESTIONS 6–10

Listen to Paul talking to a friend about his family.

What does each person do?

For questions 6–10, write a letter A–H next to each person.

You will hear the conversation twice.

EXAMPLE	ANSWER
0 Sally	<div>H</div>

PEOPLE		JOBS
6 Bill	<div></div>	A bank clerk
7 David	<div></div>	B doctor
8 Paul's mother	<div></div>	C farmer
9 Paul's father	<div></div>	D shop assistant
10 Paul	<div></div>	E stopped work
		F student
		G teacher
		H writer