

Q. 1-5

Complete the following information using **NO MORE THAN THREE WORDS AND/OR NUMBERS** for each gap.

Surname 1 _____
Given name Sharon
Address 2 _____, Tipton, TP3 4MB
Date of birth 3 _____
Type of membership annual
Amount due 4 _____ £
Credit card number 4673 9702 0361
Expiry date 5 _____

Q. 6-9

Label the diagram of the gym, using **FOUR** of the following six labels.

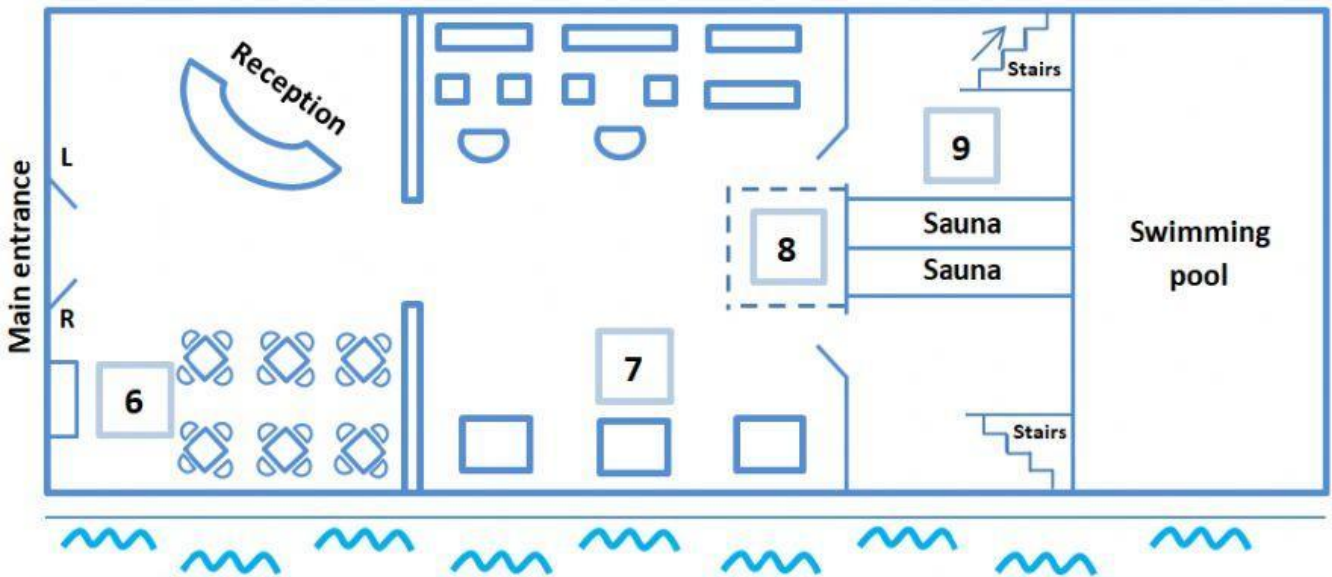

- A free weights area
 - B ladies' changing area
 - C men's changing area
 - D refreshment area
 - E treadmills
 - F various machines
- 6 _____
7 _____
8 _____
9 _____

Q. 10

Decide which pair of pie charts illustrate the membership of the gym and spa and write the appropriate letter on your answer sheet.

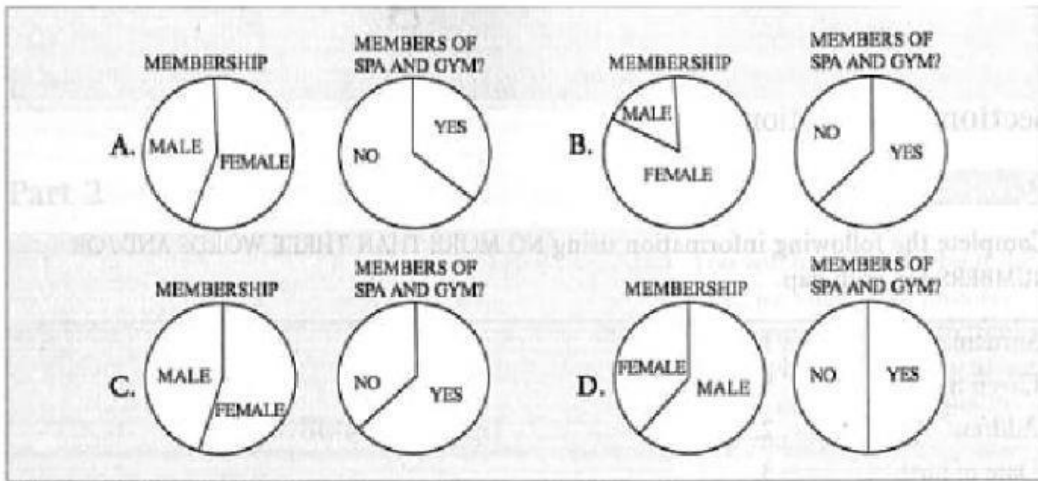

10 _____

Section 2

Question 11-20

Q. 11 and 12

Complete the following sentences using **NO MORE THAN TWO WORDS** for each gap.

11 The university has produced a _____ to inform students about the different accommodation options available.

12 All catered and self-catered accommodation is close to the _____.

Q. 13-16

In boxes 13 -16 on write

In boxes 13 -16 on your answer sheet, write

- A if the statement applies to catered accommodation
- B if the statement applies to self-catered accommodation
- C if the statement applies to private accommodation
- D if the statement is not mentioned at all by the accommodation officer

13 Meals are included in the rent.

14 This is the best accommodation for people who want to choose when they eat.

15 Most students live in this kind of accommodation.

16 This is the most expensive type of accommodation.

Q. 17-20

Decide which letter on the map shows the location of each of the following university halls of residence.

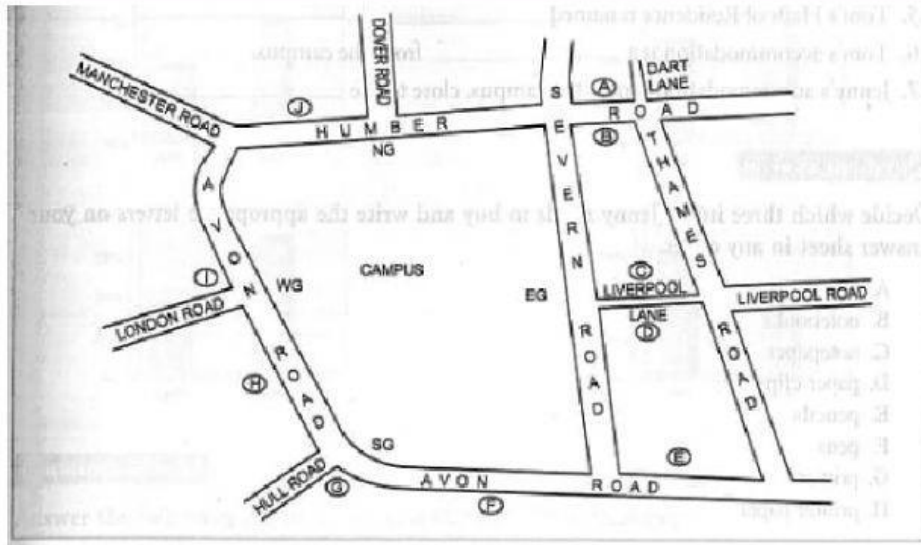

- 17 Malvern Halls
- 18 Grampian Halls
- 19 Brecon Halls
- 20 Sperrin Halls

Section 3

Question 21-30

Q. 21-24

Answer the questions using **NO MORE THAN THREE WORDS** for each answer.

- 21 When did Jenny arrive at the university? _____
- 22 What is Tom going to study? _____
- 23 What is Jenny going to study? _____
- 24 What two items have the students been given? _____

Q. 25-27

Complete the following sentences using **NO MORE THAN TWO WORDS AND/OR NUMBERS** for each gap.

- 25 Tom's Halls of Residence is named _____
- 26 Tom's accommodation is a _____ from the campus.
- 27 Jenny's accommodation is near the campus, close to the _____

Q. 28-30

Decide which three items Jenny needs to buy and write the appropriate letters on your answer sheet in **any order**.

- A binders
- B notebooks
- C notepaper

D paperclips

E pencils

F pens

G primer

H printer paper

Section 4

Question 31-40

Q. 31-33

31 Which pie chart shows the ages of the Asian students surveyed?

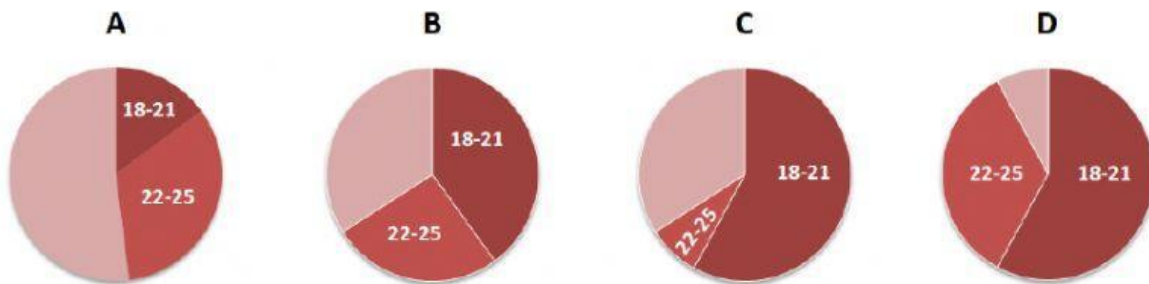

32 Which pie chart shows the main reasons Asian students wanted to study abroad?

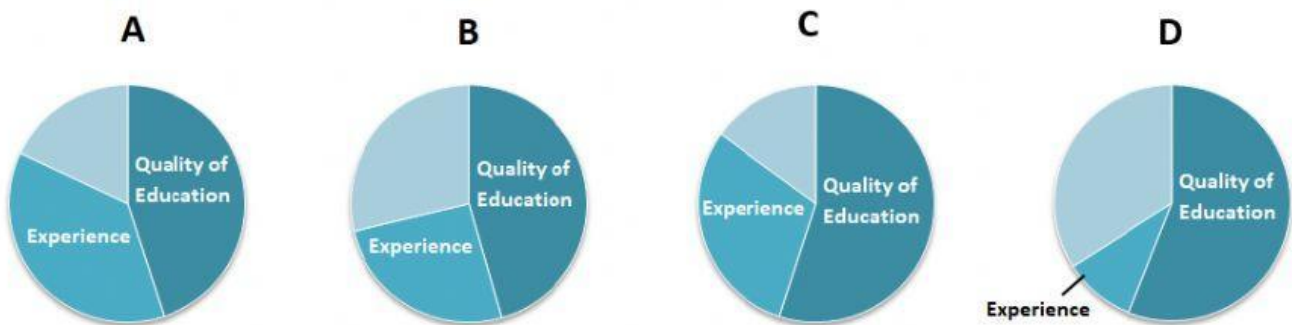

33 Which bar chart shows the percentage of Asian students who made Australia their first choice destination?

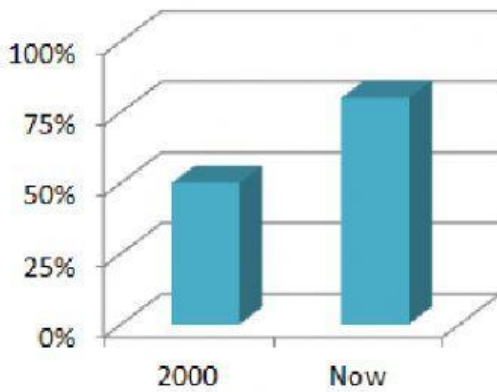
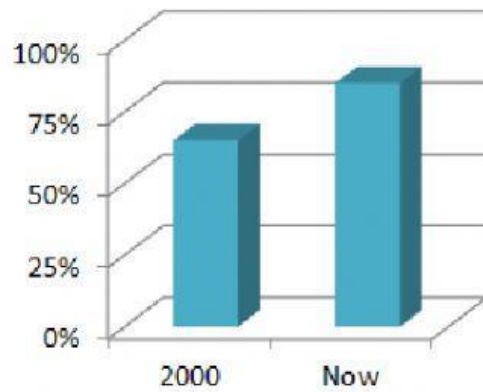
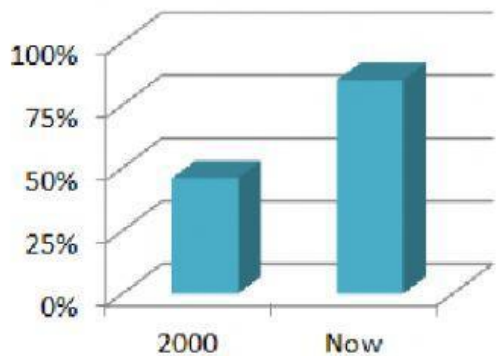
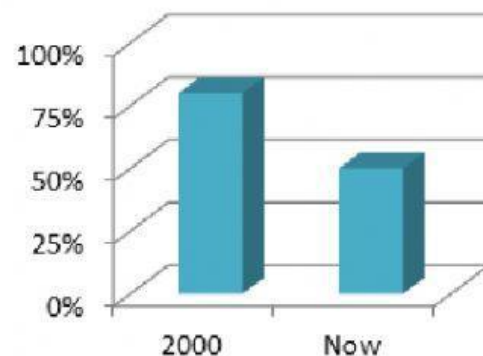
A**B****C****D****Q. 34 and 35**

Answer the following questions using **A NUMBER** for each answer.

34 Approximately how many foreign students enrolled in Australia in the year 2000? _____

35 How much did Australia's education exports rise by last year? _____

Q. 36-40

Complete the following sentences using **NO MORE THAN TWO WORDS OR NUMBERS** for each gap.

36 It became harder to get a _____ for the USA after September 11.

37 _____ of Asian students gave lower study fees as a reason for choosing Australia.

38 Asian students rank Australia number _____ in terms of educational quality.

39 _____ programmes are unlikely to reduce the number of students going abroad in the near future.

40 Asian students are increasingly using _____ to help arrange their studies abroad.