

THERE IS / THERE ARE

Look at the map of the school and choose the correct option:

Remember!

THERE IS



THERE ISN'T



THERE ARE



THERE AREN'T

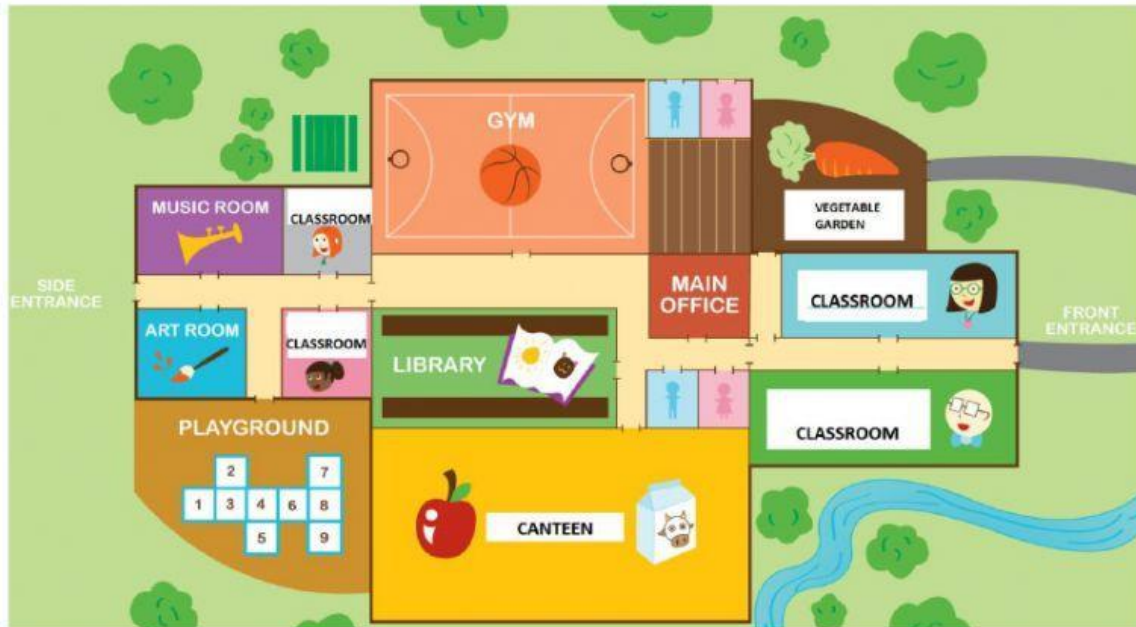

Now, read and guess

- 1) You can play instruments in this place.
- 2) You can wash your face and hands in this place.
- 3) You can study and have fun in this place.
- 4) You can eat a snack in this place.
- 5) You can play with friends in this place.
- 6) You can paint in this place.
- 7) You can grow vegetables in this place.
- 8) You can read books in this place.
- 9) You can play sports in this place.
