



Structure

Where is = Where's

Where's he?

He's in the living room.



Where's she?

She's in the bedroom.



Exercise

A Circle the correct word

1



bedroom
bedrom

2



batroom
bathroom

3



garden
gaden

4



diing room
dining room

5



living room
liling room

6



kitchun
kitchen

B

Fill in the missing letter

1



ga_r_den

2



bed__oo__

3



__ivin__ room

4



ba__ __room

5



k__t__hen

C

Read and number

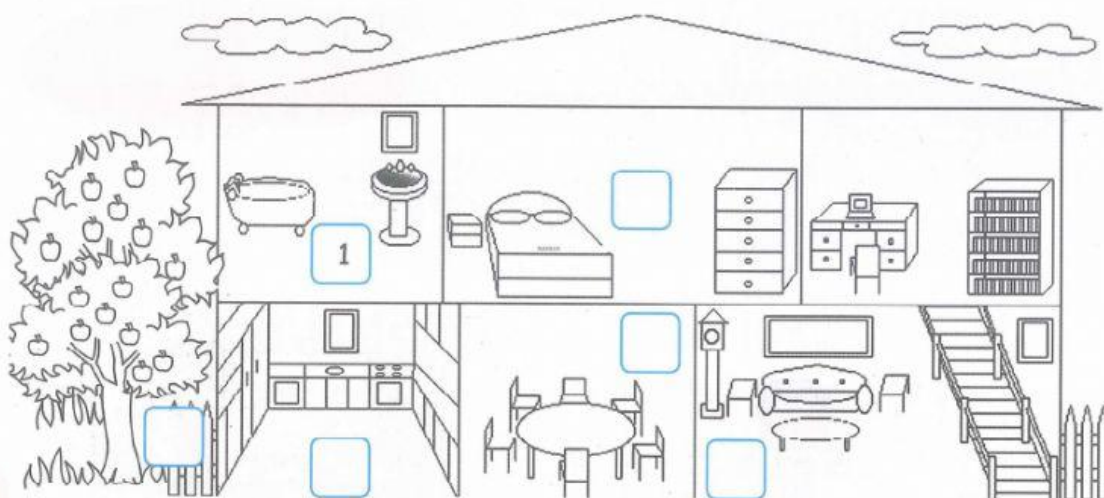

- | | | |
|-------------|------------|----------------|
| 1. bathroom | 2. garden | 3. living room |
| 4. kitchen | 5. bedroom | 6. dining room |

D Look and write

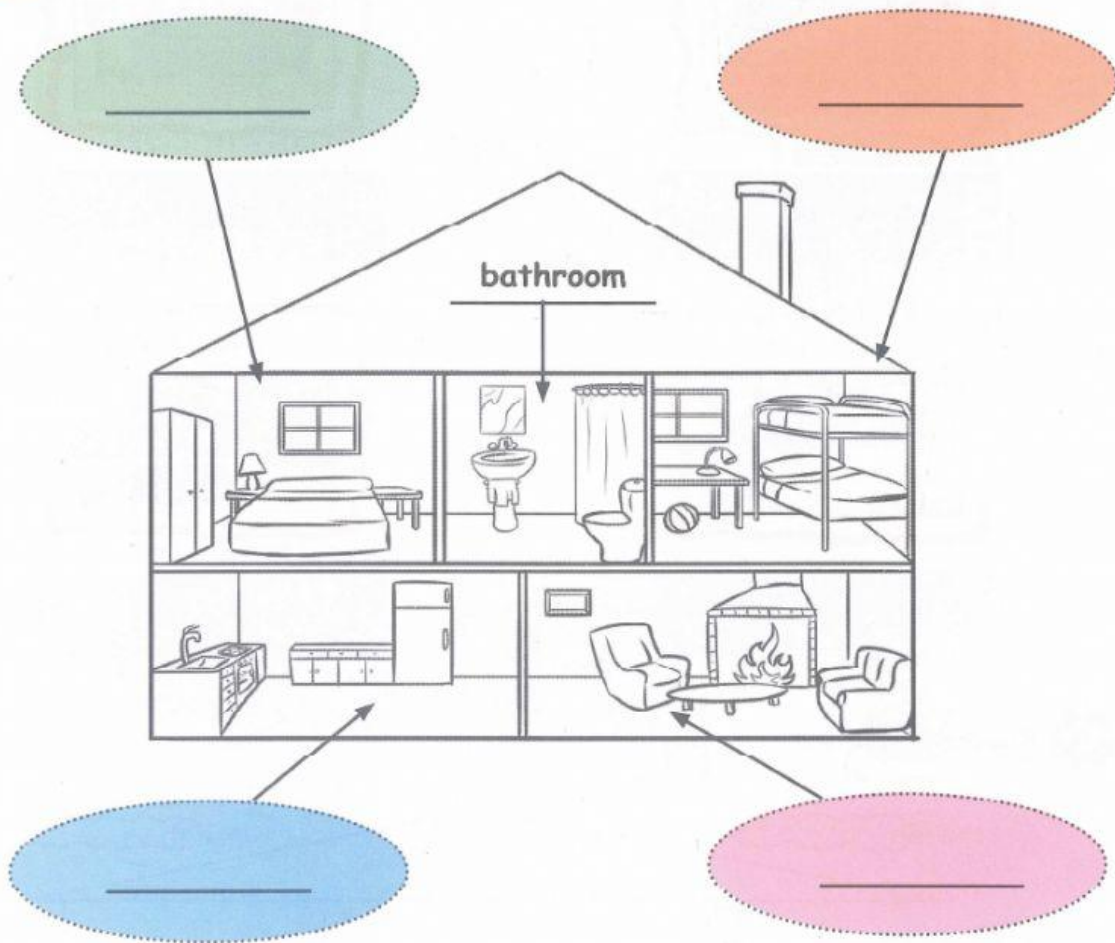

E Circle the correct sentence



- a. He's in the bathroom.
b. He's in the bedroom.



- a. He's in the bathroom.
b. He's in the kitchen.



- a. She's in the bedroom.
- b. She's in the garden.



- a. She's in the kitchen.
- b. She's in the living room.

F Look, read and write



1. Where's the pink witch? → She's in the living room.
2. _____ the purple witch? → She's _____ the bedroom.
3. Where's the _____ witch? → _____ in the bathroom.
4. _____ the red witch? → _____.
5. _____ the black witch? → _____.