

## Connect the words and the pictures

basement / car park / diamond / facilities / glass / gold /  
ground floor / jewellery / lake / pearl / skyscraper / wonderful view

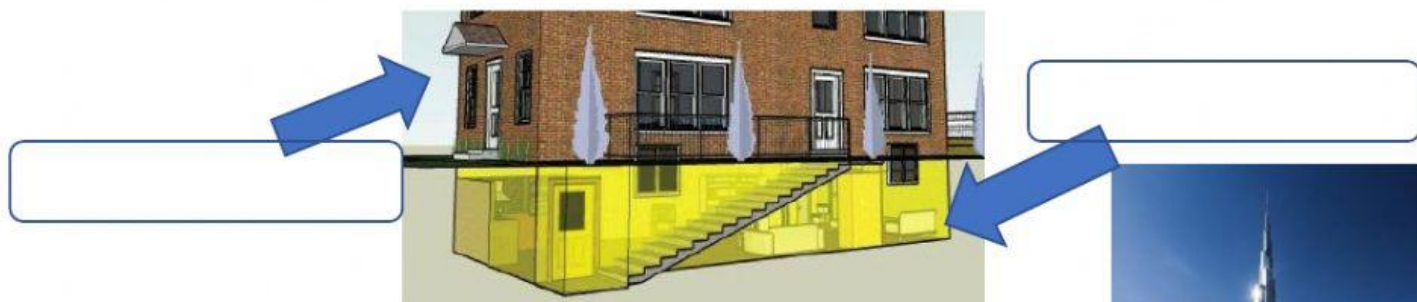

areas or buildings for a particular purpose (= цель):

for example – Sport  are stadiums, gyms, health spas, boxing arenas, swimming pools etc.

**Look at the pictures from the video. What words from task 1 can you use to talk about these pictures?**



**Watch the video:**



**Choose the correct option. Sometimes more than one answer is possible.**

- 1) The Almas Tower is the tallest business tower / hotel / shopping centre in the Middle East.
- 2) The Almas Tower is in the sea / on an island / in a lake.
- 3) The Almas Tower is one large tower / two towers joined together / four towers joined together.
- 4) The outside of the Almas Tower is metal / glass / plastic.
- 5) Dubai's pearl / gold / diamond exchange is in the Almas Tower.
- 6) Harley Davidson / Toyota / Ford has its head office in the building.
- 7) The Almas Tower has offices / restaurants / hairdressers.
- 8) At the top of the tower there is a car park / viewing area / five-star restaurant.

**Watch the video again. What do the numbers refer to?**

- |          |                                  |
|----------|----------------------------------|
| a) 360   | Harley Davidson offices          |
| b) 68    | number of skyscrapers            |
| c) 66    | number of spaces in the car park |
| d) 48    | metres tall                      |
| e) 1,700 | floors                           |

**Your office is going to receive some English-speaking visitors. You are going to take them to a famous or unusual building in your town/city. Think about and prepare notes on ...**

- why the building is important (age, purpose, etc.)
- where the building is located
- what is inside the building (facilities, offices, etc.)
- why it is interesting to visitors
- how to get to the building