

Listening

Table completion

- ① You are going to hear a college head teacher giving information to some students about a college event. Before you listen, look at the table. What kind of information do you need for each gap?

Natural History day: morning events

All events begin at 9.30. You **must** attend one of these.

Name of event	Theme or topic	Type of event	Location
Dogs might fly	Animal 1	Lecture and 2	Room 27
Flowers talk	How plants might 3	Video presentation	4
A world in your 5	Local animal and plant life	6	Local park
I'm not touching that	Snakes and other 7	Workshop	8 lab

- ② Now listen and complete the table above. Write **NO MORE THAN TWO WORDS OR A NUMBER** for each answer.

Labelling a plan

- ③ How do you get to room F from the main hall? Complete these directions with words from the box. There is one word you do not need, and there is one word you will need to use twice.

end first follow leave left opposite
pass right second turn

1 the main hall by the door 2 reception and
3 left. 4 the corridor until you 5 Room
J, and turn 6 . At the 7 of the corridor, turn
8 . Room F is through the 9 door on your
10 .

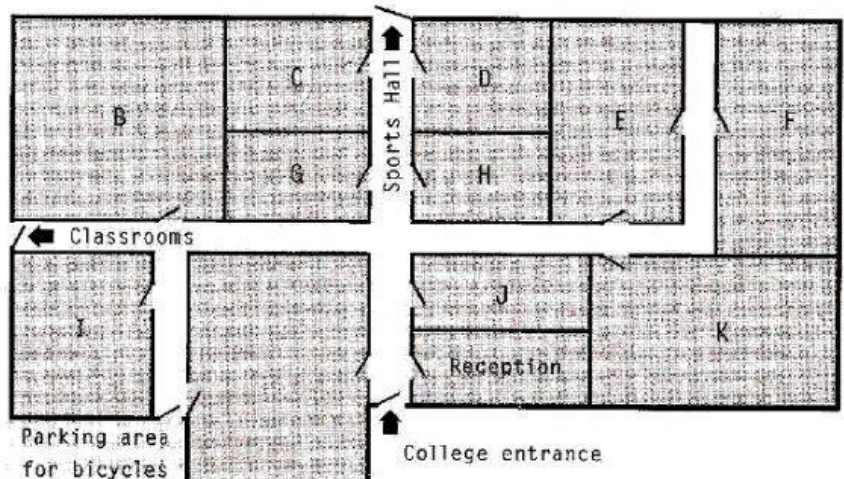

4  Now listen and label the plan. Write the correct letter, A–K, next to Questions 1–5.

1	Administration office	<input type="text"/>
2	Café	<input type="text"/>
3	Student common room	<input type="text"/>
4	Lockers	<input type="text"/>
5	Library	<input type="text"/>