

# Unit 7: That's my school.

I. Complete the sentence:

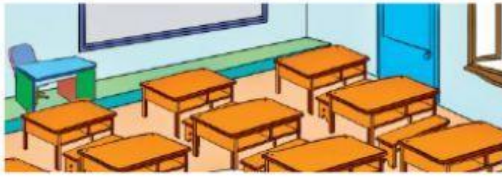

1. That is my \_\_\_\_\_



2. That is the \_\_\_\_\_

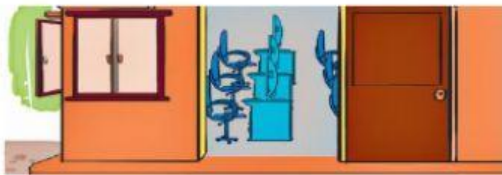

3. That is the \_\_\_\_\_



4. That is the \_\_\_\_\_

II. Listen and choose the correct picture:



1. A ☐



B ☐



C ☐



2. A ☐

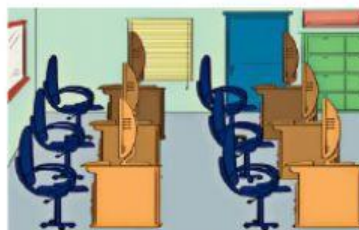

B ☐



C ☐



3. A ☐



B ☐



C ☐

### III. Listen and number:



### IV. Read and choose the correct answer:

Look at my school. It is beautiful. That is my classroom. It is big. And that is the computer room. It is new but small. Look at the library. It is large and new. And look at the gym. It is big but old.



1. The classroom is **big** / **small**.
2. The computer room is **big** / **small**.
3. The library is **old** / **new**.
4. The gym is **new** / **big**.

### V. Read and match

- |                          |                             |
|--------------------------|-----------------------------|
| 1 Is that your school?   | a No, it isn't. It's old.   |
| 2 Is the library big?    | b Wow! It's very nice.      |
| 3 Is the music room new? | c No, it isn't. It's small. |
| 4 This is my school.     | d Yes, it is.               |