

Geography

INSTRUCTIONS

- Read the questions carefully.
- Answer ALL questions on the lined paper provided.
- RULE OFF AFTER EACH SECTION
- Check ALL of your answers

Section A

Examine the types of houses in which people live, in South Africa and answer the questions that follow.

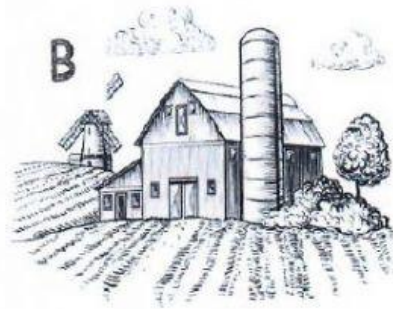
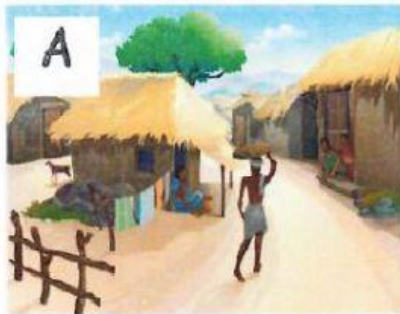

1. Which of these houses, do you think, has taps inside?
2. Which of these houses do you think has electricity inside?
3. Where can you get water from if there are no taps inside?
4. What can you use when you have no electricity to:
a.) cook b.) make light

(4)

Section B

Choose the word in brackets that works best for each sentence.

1. Ethan (wants/needs) air to breathe.
2. Sibulele (wants/needs) a chocolate after supper.
3. Aiden (wants/needs) medical attention after being injured in a rugby match.
4. Jordan (wants/needs) a new cellphone. (

Section C

Study the diagrams below and answer the questions that follow.

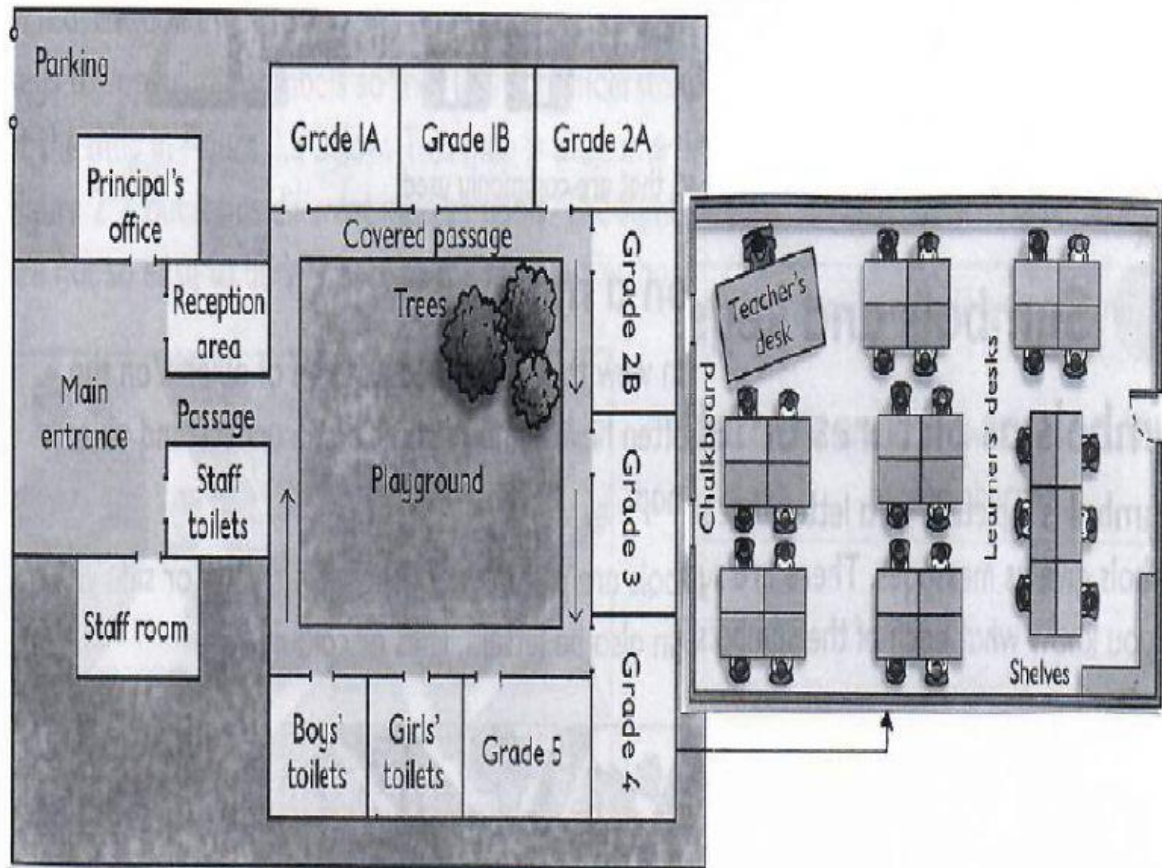

1. Plan views are views from _____.
2. Choose the correct word in brackets: A plan view shows the (size/detail/position) of objects on the ground.
3. How many learners are in this Grade 4 classroom?
4. How many classrooms does this school have?
5. Are the Grade 1 classrooms closer to the principal's office or closer to the staffroom?

(5)

Section D

Examine the map below and follow the instructions given. You will receive a cut out of this map, exactly the same as the one on this page. Stick the cut out onto your lined paper and complete the instructions on your page.

1. Label the following continents : Africa, North America and Antarctica (3)
 2. Label the Indian and Atlantic Oceans (2)
- [5]
-

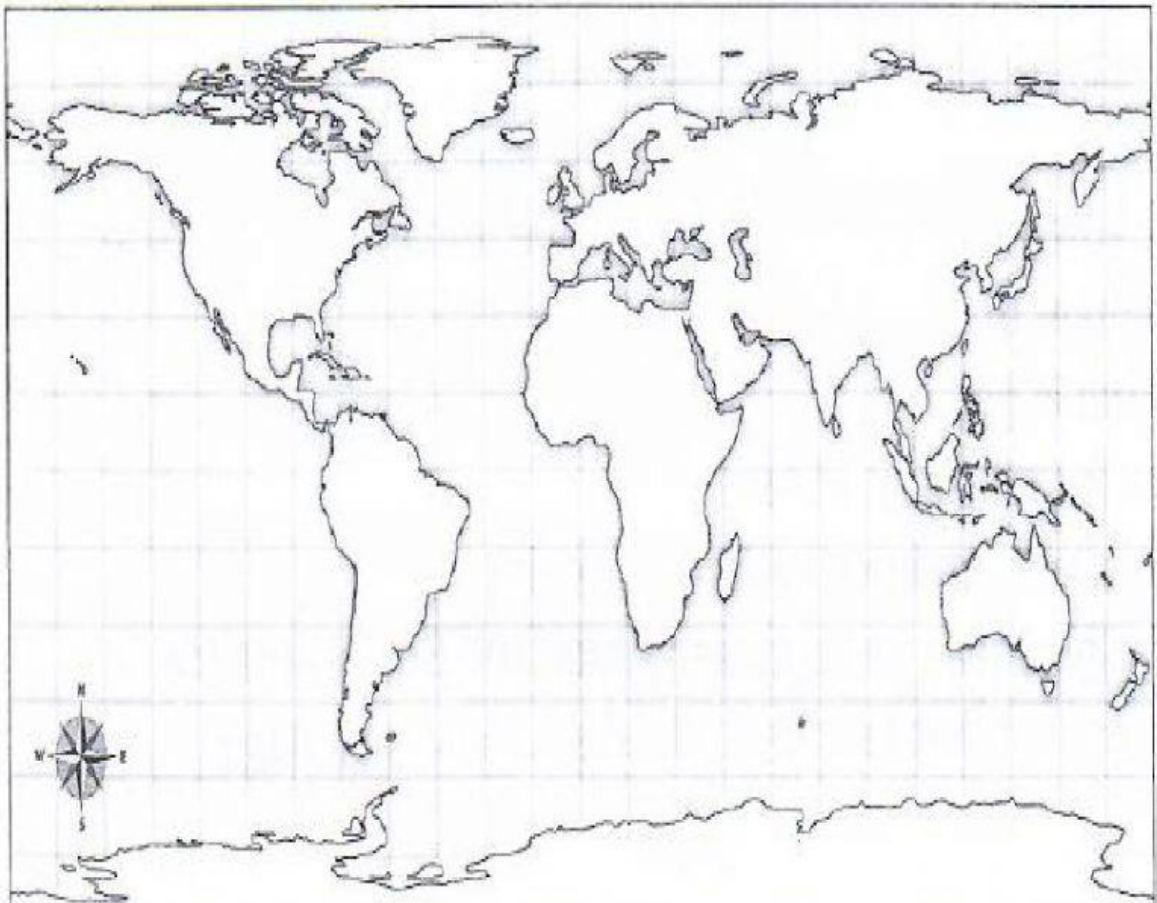

Section E

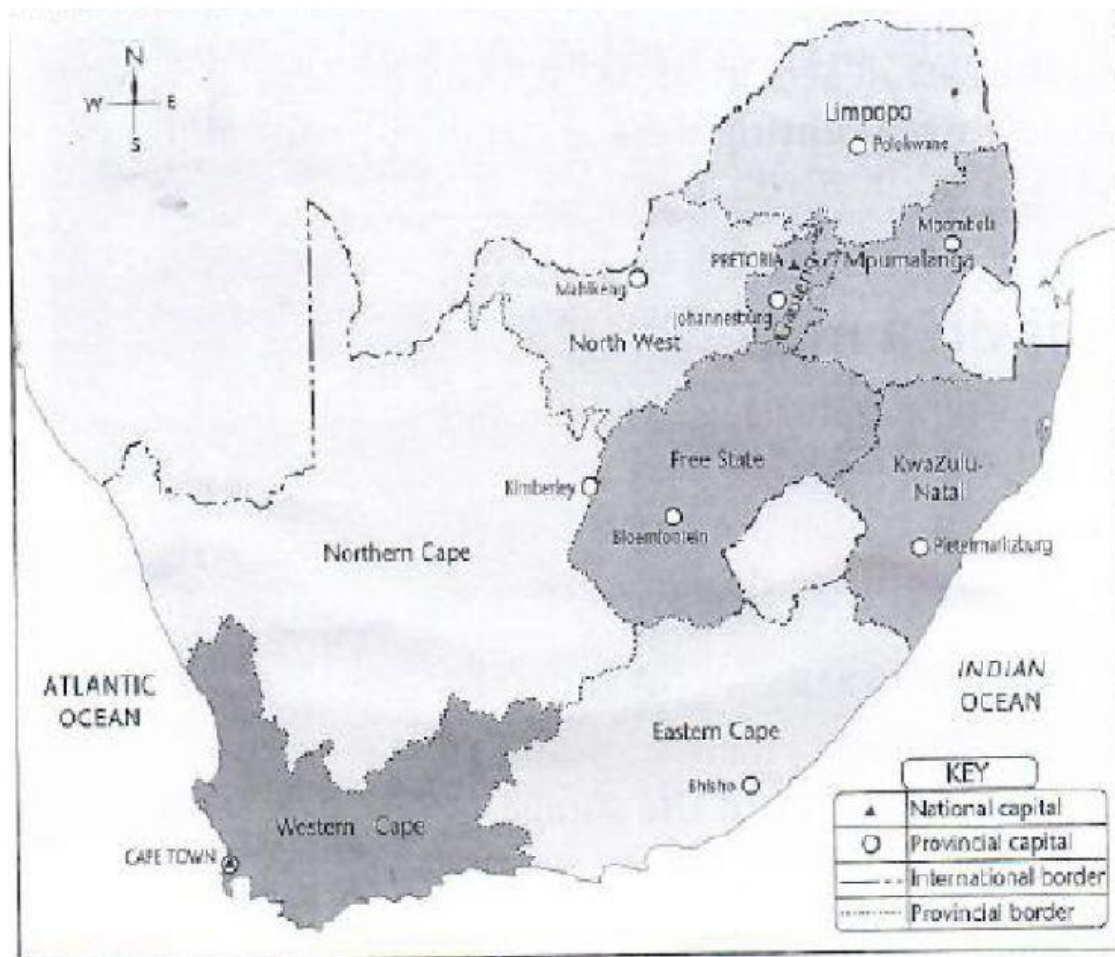



1. South Africa consists of _____ provinces.
2. Which province is the biggest?
3. Which province is the smallest?
4. Name your provincial capital.
5. Which direction is:
 - a.) Bhisho from Kimberly
 - b.) Free State from the Northern Cape
6. Which country is completely surrounded by South African provinces? (7)