

# Lesson 7: Where's the Cafeteria?

## Vocabulary

### 1. Listen and circle

Listen to five short dialogs and decide where the speakers are.  
Circle the best answers.

1



A



B



C

2



A



B



C

3



A



B



C

4



A



B



C

5



A



B



C



# My World

## 2. Complete

Complete the sentences. Write out the numbers in parentheses ( ). For example, (5) = fifth.

1. The computer lab is on the ..... (3) floor.
2. The principal's office is the ..... (4) door on your right.
3. Anthony is the ..... (2) son in the family.
4. Saturday is the ..... (6) day of the week.
5. July is the ..... (7) month of the year.
6. The nurse's office is on the ..... (1) floor.

## 3. Complete

Complete the dialogs with the correct words. The first letter of each answer is given.

1. A: I'm looking for Mr. Page. Has he arrived?  
B: I don't know. Why don't you go to the t\_\_\_\_\_ r\_\_\_\_\_ and see for yourself?
2. A: Where's the computer lab?  
B: It's u\_\_\_\_\_, on the third floor.
3. A: I need some information about Balinese culture for my social studies report.  
B: Go to the l\_\_\_\_\_. There are lots of books about Balinese culture there.
4. A: Painting makes my hands dirty.  
B: Yeah. I'm going to wash my hands. I'm going to the r\_\_\_\_\_.
5. A: Is the science lab on this floor?  
B: No. It's d\_\_\_\_\_, on the first floor.
6. A: Today I was late and had to run to class. I bumped into Mr. Clark and he got so angry.  
B: Nobody is allowed to run in the h\_\_\_\_\_. That's the rule. You know that.



# Lesson 7: Where's the Cafeteria?

## Grammar

### 4. Listen and write

Look at the school map and listen to someone describing the location of some places. Identify the places and write them in the given spaces.

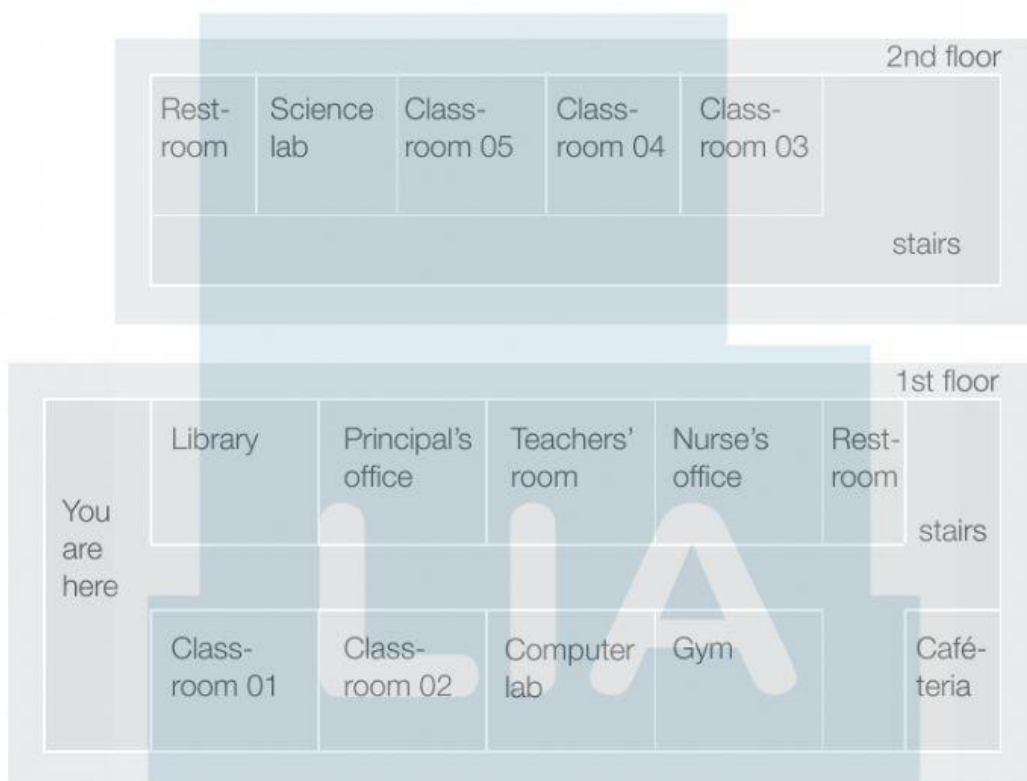

1. ....
2. ....
3. ....
4. ....
5. ....



## 5. Write

Look at the school map in Activity 4. Then, complete the sentences with the right prepositions.

1. The principal's office is \_\_\_\_\_ the library and the teachers' room.
2. The computer lab is \_\_\_\_\_ classroom 02.
3. The nurse's office is \_\_\_\_\_ the gym.
4. The teachers' room is over there. It's the third door \_\_\_\_\_.
5. The science lab is upstairs. It's \_\_\_\_\_.
6. Classroom 05 is \_\_\_\_\_ the science lab and classroom 04.
7. The gym is \_\_\_\_\_ the computer lab, opposite the cafeteria.
8. The library is \_\_\_\_\_ classroom 01.

## 6. Complete

Complete the school map by reading the information below it.

You are here

Entrance

The rest room is at the end of the hallway. It's on your right.

The computer lab is next to the teachers' room

The principal's office is opposite the nurse's office

There are eight rooms on the first floor.

The gym is next to the nurse's room.

The teachers' room is opposite the library

The library is between the locker room and the nurse's office.

The locker room is near the entrance. It's the first door on the left.

