



Full name:.....

Worksheet 7	Topic: Leisure and Education		WID: IELTS5.0_07_L
Skills	Listening: listen to and understand directions from one place to another pts/10	QR code:
	Listening skills: map/table/note/form completion pts/10	

Exercise 1. [IELTS Listening: Table completion] Listen and complete the tables below.**[1-4] Write ONE WORD ONLY for each answer.**

Health Centers		
Name of centre	Doctor's name	Advantage
The Harvey Clinic	Example Dr. __Green__	Especially good with 1 _____
The 2 _____ health practice	Dr. Fuller	Offers 3 _____ appointments
The Shore Lane Health Centre	Dr 4 _____	

[7-10] Write NO MORE THAN TWO WORDS AND/OR A NUMBER for each answer.

Talks for patients at Shore Lane Health Centre			
Subject of talk	Date/Time	Location	Notes
Giving up smoking	25 th Februar at 7pm	Room 4	Useful for people with asthma or 7 _____ problems
Healthy eating	1 st March at 5 pm	The 8 _____ (shore lane)	anyone welcome
Avoiding injuries during exercise	9 th March at 9 _____	Room 6	For all 10 _____



Exercise 2. [IELTS Listening: Note completion] Listen and complete the note. Write **NO MORE THAN THREE WORDS AND/OR A NUMBER** for each answer.

Event Details

Type of event: Example Dragon Boat Race

Race details

- Day & date: 1 _____
- Place: Brighton 2 _____
- Registration time: 3 _____

Sponsorship

- aim to raise over 4 _____ as a team and get a free t-shirt
- free Prize Draw for trip to 5 _____

Team details

- must have crew of 20 and elect a 6 _____
- participants under 18 need to have 7 _____ to enter
- need to hire 8 _____
- advised to bring extra 9 _____
- must choose a 10 _____ for the team

Exercise 3. [IELTS Listening: Note completion – Table completion]

A. Complete the note. Write NO MORE THAN THREE WORDS AND/OR A NUMBER for each answer.

The National Arts Centre

Well known for: 11 _____

Complex consists of: concert room
theatres
cinemas
art galleries
public library
restaurants



12 _____

Historical background:

1940 – area destroyed by bombs

1960s – Centre was 13 _____

In 14 _____ - open to public

Managed by:

15 _____

Open:

16 _____ days per year

B. Complete the table. Write NO MORE THAN THREE WORDS AND/OR A NUMBER for each answer.

Day	Time	Event	Venue	Ticket price
Monday and Tuesday	7.30 p.m	'The Magic Flute' (opera by Mozart)	17 _____	From £8.00
Wednesday	8.00 p.m	18 _____ (Canadian film)	Cinema 2	£19 _____
Saturday and Sunday	11 a.m. to 10 p.m	20 _____ (art exhibition)	Gallery 1	free

Exercise 4. [IELTS Listening: Form completion – Table completion] You are going to hear a conversation between a hotel receptionist and a customer who has come to make a booking.

A. Complete the form below. Write NO MORE THREE WORDS AND OR/NUMBERS for each answer.

Hotel information	
E.g. Name of accommodation:	(0) Carlton Hotel
Length of stay:	3 nights
Ages of children:	(1) _____
Rooms available:	Two en-suites at £270
Price inclusive of:	(2) _____



Payment method:	credit card
Name:	Michael (3) _____
Date of birth:	(4) _____ 1968
Address:	273, Stanton Court, London
Post code:	(5) _____
Telephone:	08773 (6) _____

B. Complete the table below. Write NO MORE THREE WORDS AND OR/ A NUMBER for each answer.

Transport Options			
Mode of Transport	Cost	Arrangements	Travel time to town
Taxi	Approximately (7) £ _____	Pick up from the hotel	10 minutes
Bus	£2 per person	Walk down Oak Tree (8) _____	15 minutes
Walking	-----	Walk through (9) _____	(10) _____

Exercise 5. [IELTS Listening: Note completion – Table completion]

A. Complete the notes below. Write NO MORE THAN THREE WORDS for each answer.

Notes on Sports Club

E.g. Name of club: Kingswell

Facilities available: Golf
1 _____
2 _____

Class available: Kick-boxing
3 _____

Additional facility: 4 _____ (restaurant opening soon)



B. Complete the table below. Write NO MORE THAN TWO NUMBERS for each answer.

MEMBERSHIP SCHEMES					
Type	Use of facilities	Cost of classes	Times	Joining fee	Annual subscription fee
GOLD	All	Free	Any time	£250	5. £_____
SILVER	All	6. £_____	From 7. _____ to _____	£225	£300
BRONZE	Restricted	£3	From 10.30 to 3.30 weekdays only	£50	8. £_____

Exercise 6. [IELTS Listening: Map completion] Label the plan below. Choose FIVE answers from the box and write the correct letters A-I next to questions 11-15.

Town Library

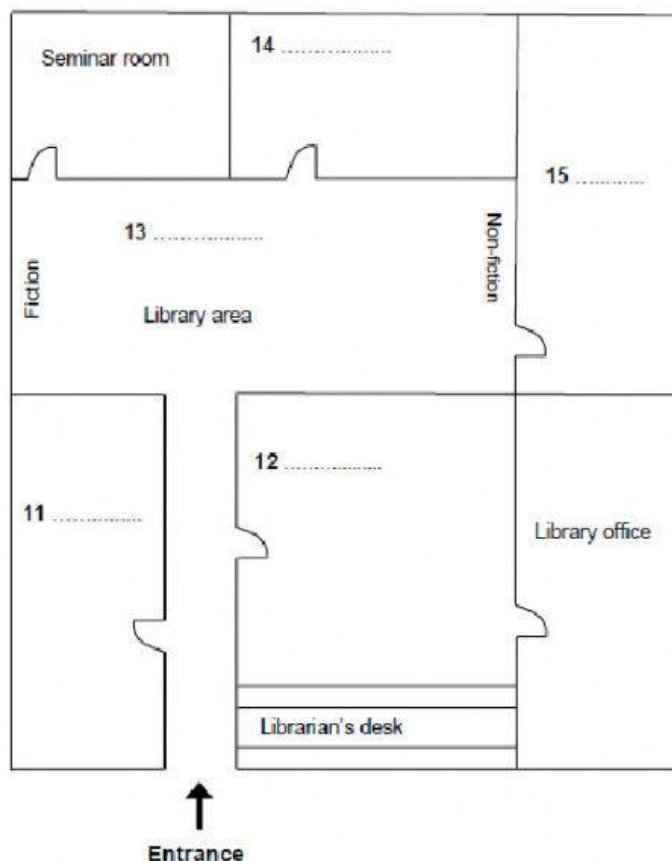

- A Art collection
- B Children's books
- C Computers
- D Local history collection
- E Meeting room
- F Multimedia
- G Periodicals
- H Reference books
- I Tourist information



Exercise 7. [IELTS Listening: Form completion – Map completion]

A. Complete the form below, using NO MORE THAN THREE WORDS AND/OR A NUMBER for each answer.

Travel Safe	
INSURANCE PLC	
Department:	<u>Motor Insurance</u>
Client details:	
Name:	Elisabeth (1) _____
Date of birth:	8.10.1975
Address:	(2) _____ (street) Callington (town)
Policy number:	(3) _____
Accident details:	
Date:	(4) _____
Time:	Approx. (5) _____
Supporting evidence:	(6) _____
Medical problems (if any):	(7) _____ injuries

B. Label the diagram/plan below. Write the correct letter, A-G, next to questions 8-10.

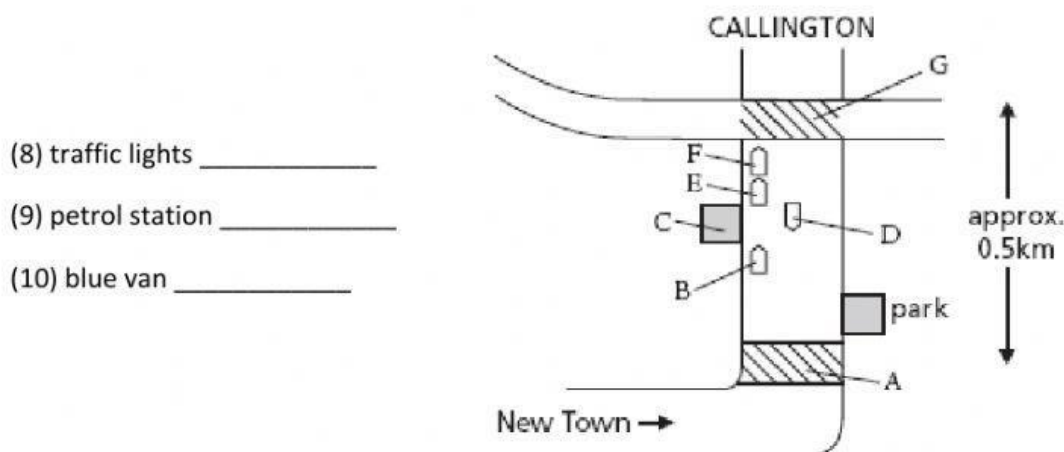



Exercise 8. [IELTS Listening: Map completion] Label the map below. Write the correct letter, A-I next to questions 14-20.

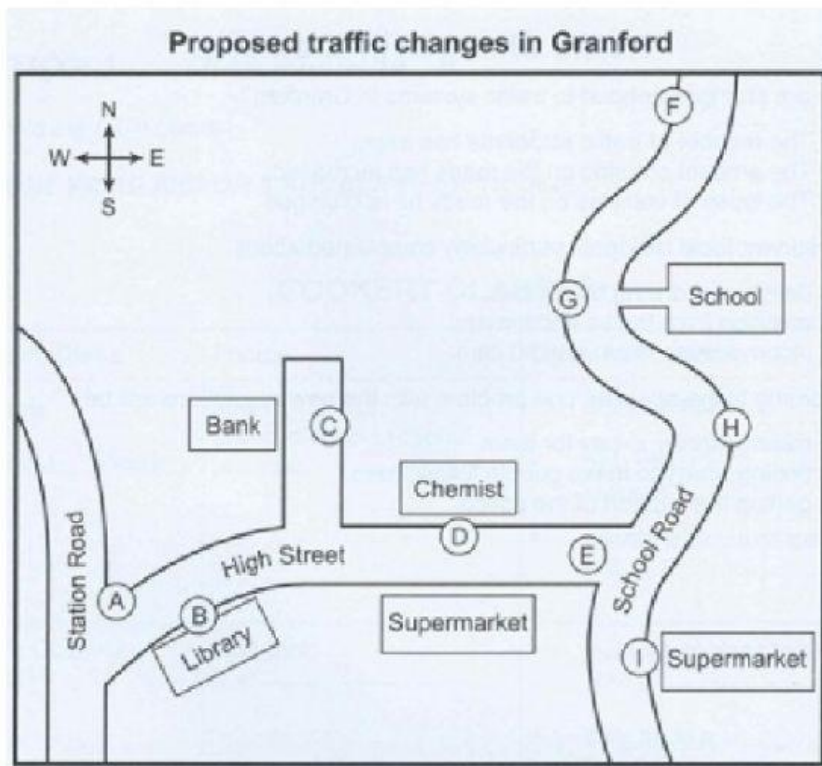

- | | |
|---|-------|
| 14. New traffic lights | _____ |
| 15. Pedestrian crossing | _____ |
| 16. Parking allowed | _____ |
| 17. New 'No Parking' sign | _____ |
| 18. New disabled parking spaces | _____ |
| 19. Widened pavement | _____ |
| 20. Lorry loading/ unloading restrictions | _____ |