

The inhabitants of the Iberian Peninsula

1. Label the houses Iberian or Celtic. Then write the words in the correct column.

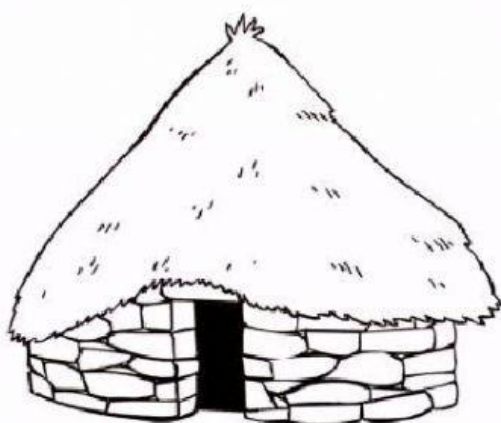

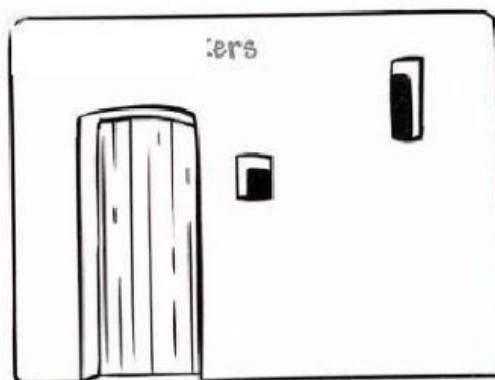

craftworkers farmers fortified villages forts
metal workers rural areas stone streets warriors

2. Match the sentences about the Iberian and Celts.

The Iberians lived in the



east and southeast of the Iberian Peninsula.

The Celts lived in the



north and centre of the Iberian Peninsula.