

## THE DIARY OF ANNE FRANK



**A.**

*Thursday, 9 July 1942*

*The hiding-place is in Father's office building. On the bottom floor is the warehouse, and next to it an entrance to the office, which is upstairs. There are two offices — a front one which is big and light, and a small dark one at the back(...).*

*Up on the third floor is our 'Secret Annexe'. There are some attics for storage on the left, and on the right is the door to our hiding-place. It's surprising that there are so many rooms behind that small grey door. Margot and I share a small room, and Mother and Father's bedroom is also our sitting-room. Up the stairs again is a big light room which will be the kitchen and Mr and Mrs van Daan's bedroom. There is a very small room for Peter, their son, and another attic. So that's our lovely Annexe!*

Source: <https://pggarodialibrary.files.wordpress.com/2014/07/the-diary-of-a-young-girl.pdf>

- 1 - Warehouse
- 2 - Kitchen of the Opekta Spice Company
- 3 - Access door to Otto Frank's private office
- 4 - Viktor Kugler's office
- 5 - Johannes Kleiman, Miep Gies' and Bep Voskuijl's offices
- 6 - Warehouse
- 7 - Attic
- 8 - The bookcase revolving door entrance
- 9 - Washroom and toilet

- 10 - Otto, Edith and Margot Frank's bedroom
- 11 - Anne Frank and Fritz Pfeffer's bedroom
- 12 - Living room, kitchen area and Hermann e Auguste van Pels's bedroom
- 13 - Peter van Pelt's bedroom and ladder to attic
- 14 - Attic
- 15 - Loft

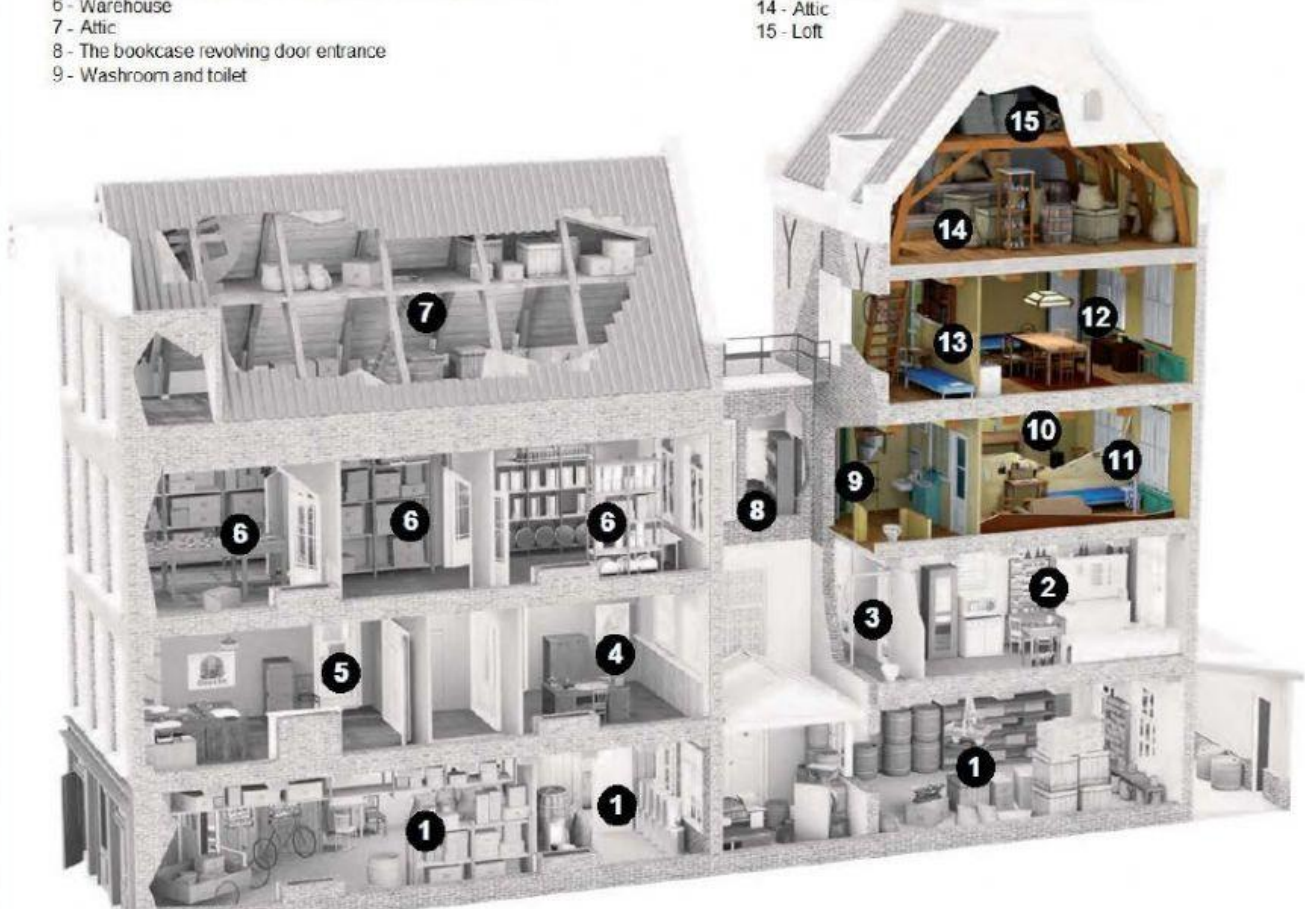

Source: [www.annefrank.org/de/downloads/filer\\_public/b6/84/b6849418-8f25-4382-a00a-04047b65ee46/leren\\_met\\_anne\\_franc\\_por.pdf](http://www.annefrank.org/de/downloads/filer_public/b6/84/b6849418-8f25-4382-a00a-04047b65ee46/leren_met_anne_franc_por.pdf)

**1. Are the sentences TRUE OR FALSE?**

- a. The hiding-place is in a friend's house
- b. There are two offices
- c. The "secret annexe" is on the second floor.
- d. Anne shares her room with her sister Margot.
- e. Mother and father's room is also the kitchen.
- f. There is a very big room for Peter.

**2. Now, answer the questions – Estas preguntas respondelas dentro de la tarea en la plataforma.**

- a. What is there on the bottom floor?
- b. How many offices are there on the first floor?
- c. Is there a kitchen on the first floor?
- d. What colour is the door that leads to the annexe?
- e. Which rooms are there on Anne's bedroom floor?
- f. Who is Peter?